

N O	MODEL		XC12W1-MYC(JET 14 125/X8B)		
	DATE		Mar-18	Mar-18	Mar-18
	BASIC COLOR		RDAE	BPAE	WAAE
	COLOR CODE		R-010CA/GY-7450U	BU-289S/GY-7450U	WH-006/GY-7450U
	Description	Parts Number	RED+GRAY	BLUE+GRAY	WHITE+GRAY
1	R FR. COVER	64301-X8A-000	RD	BP	WA
2	L FR. COVER	64302-X8A-000	RD	BP	WA
3	R BODY COVER	83500-X8A-000	RD	BP	WA
4	L BODY COVER	83600-X8A-000	RD	BP	WA
5	RR. CENTER COVER	83650-X8A-000	RD	BP	WA
6	R RR. SIDE COVER	83530-X8A-000	AE	AE	AE
7	L RR. SIDE COVER	83630-X8A-000	AE	AE	AE
8	R BODY LOWER COVER	83510-X8A-000	AE	AE	AE
9	L BODY LOWER COVER	83610-X8A-000	AE	AE	AE
10	WIND SCREEN GARNISH	67110-X8A-000	AE	AE	AE
11	FR. FENDER	61100-X8A-000	K	K	K
12	METER UP COVER	53208-X9B-000	●	●	●
13	R BACK MIRROR	88110-XPA-000	K	K	K
14	L BACK MIRROR	88120-XPA-000	K	K	K
15	RR. CUSHION	52400-AP1-000	K	K	K
16	FR. R CUSHION	51400-X8A-000	K	K	K
17	FR. L CUSHION	51500-X8A-000	K	K	K
18	SPEEDMETER ASS'Y	37200-X8A-010	●	●	●
19	RR. CARRIER	81200-X8A-000	K	K	K
20	BODY COVER EMBLEM	87128-X8B-000	●	●	●
21	R. SIDE COVER STRIPE	87131-X8B-000	T1	T2	T3
22	L. SIDE COVER STRIPE	87132-X8B-000	T1	T2	T3
23	RH. Inner box garnish	81133-X8A-000	AE	AE	AE
24	FR. COVER LID EMBLEM	87552-L6G-900	●	●	●
25	HNDL. PIPE UP. HOLDER	53131-AWU-000	KH	KH	KH
26	FRAME NUMBER LID	64318-ALA-000	BK	BK	BK
27	L. CRANK CASE COVER	11341-XMA-020	K1	K1	K1
28	LH. INNER BOX GARNISH	81143-X8A-000	AE	AE	AE
29	R.FR COVER STRIPE	87123-X8B-000	T1	T1	T2
30	L.FR COVER STRIPE	87124-X8B-000	T1	T1	T2
31	R.BODY COVER STRIPE B	87125-X8B-000	T1	T1	T2
32	L.BODY COVER STRIPE B	87126-X8B-000	T1	T1	T2
33	SYM STRIPE	87170-U11-000	T2	T2	T1
34	R.ODY COVER STRIPE B	87129-X8B-000	●	●	●
35	L BODY COVER STRIPE B	87130-X8B-000	●	●	●
36	HANDLE HOLDER EMBLEM	87170-X8B-000	●	●	●

# 引擎部品目錄

## CONTENTS-ENGINE GROUP

**E01 SHROUD ASSY**



**E02 CYLINDER HEAD**

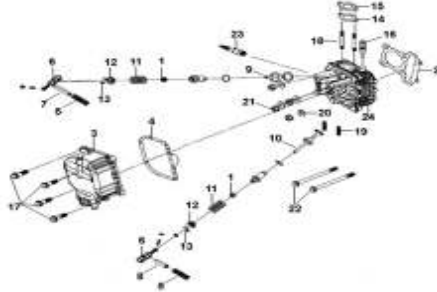

**E03 CAM SHAFT&CYL. HEAD L. SIDE COVER**

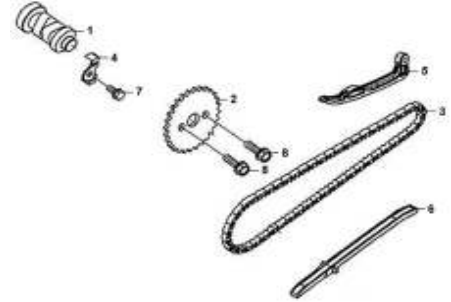

**E04 R CRANK CASE&OIL PUMP ASSY**

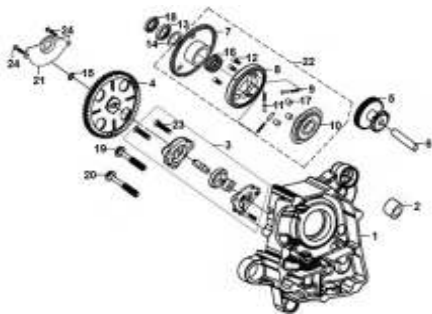

**E05 CYLINDER**

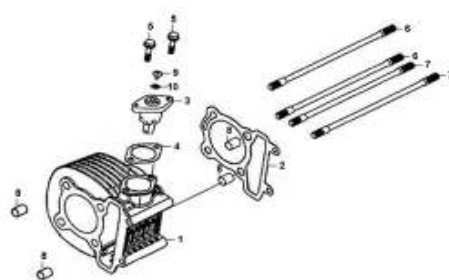

**E06 R. CRANK CASE COVER**

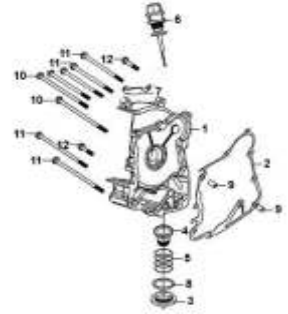

**E07 AC GEN. ASSY**



**E08 L. CRANK CASE COVER**

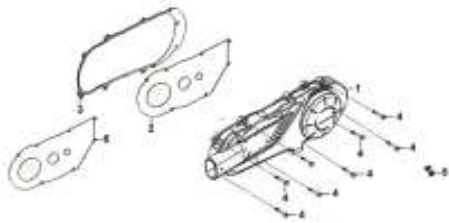

**E09 MOVABLE DRIVE FACE ASS'Y**

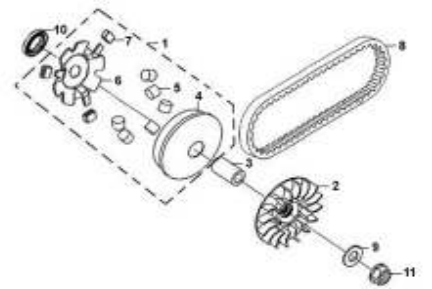

**E10 DRIVEN PULLEY ASS'Y**

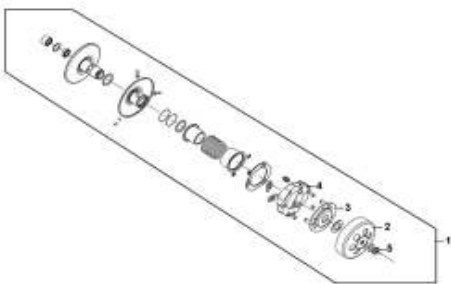

**E11 MISSION CASE&DRIVE SHAFT**

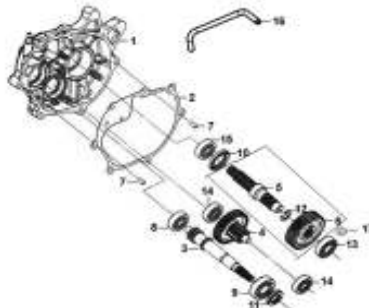

**E12 L. CRANK CASE**

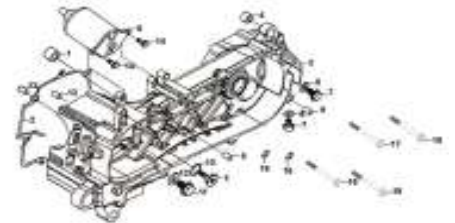

# 引擎部品目錄

## CONTENTS-ENGINE GROUP

E13 CRANK SHAFT

E14 ECU Set

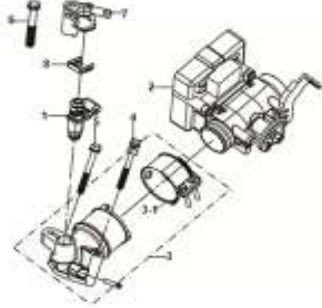

# 車架部品目錄

## CONTENTS-FRAME GROUP

F01 Meter • Wind screen



F02 Cable • Switch • Handle Lever

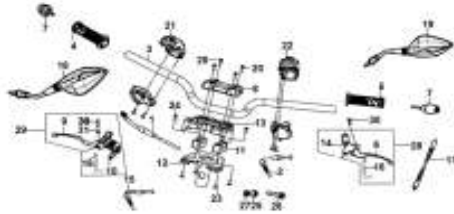

E03 CAM SHAFT&CYL. HEAD L.

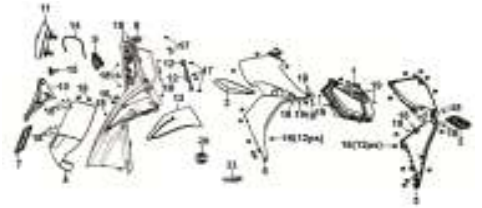

F04 Floor Panel • Center Cover

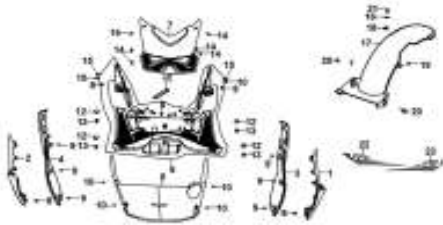

F05 Body Cover

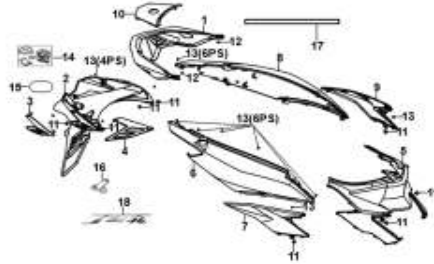

F06 Steering Stem • Front Cushion

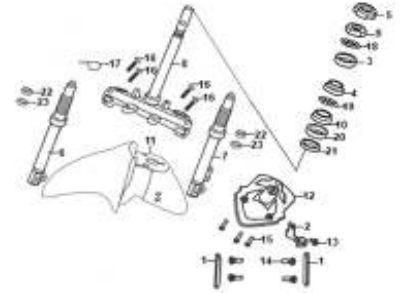

F07 Brake System ASSY

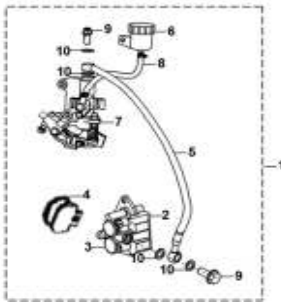

F08 Front Wheel

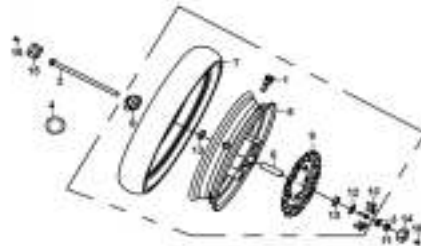

F09 Rear Wheel

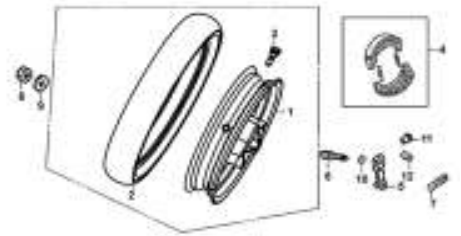

F10 Seat • Rear Grip

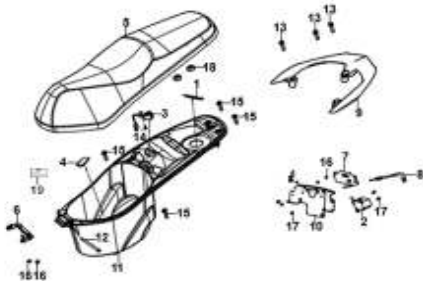

F11 Fuel Tank

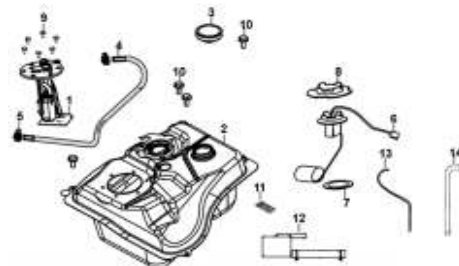

F12 Battery • Tool Box

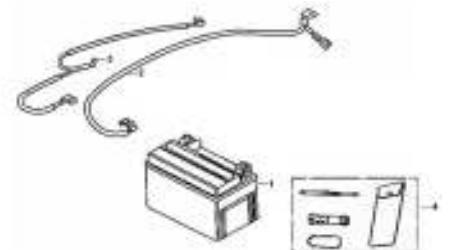

# 車架部品目錄

## CONTENTS-FRAME GROUP

F13 Air Cleaner

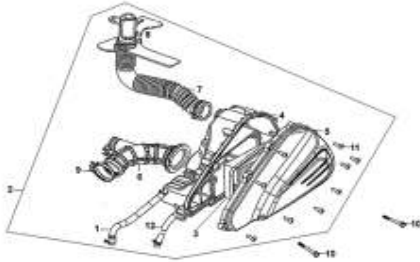

F14 Exhaust Muffler

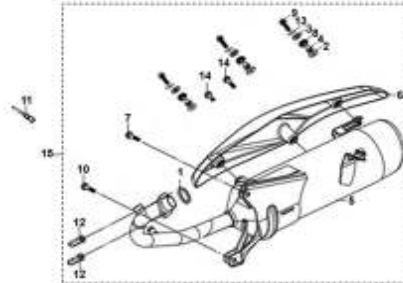

F15 Main Stand • Kick Starter Arm

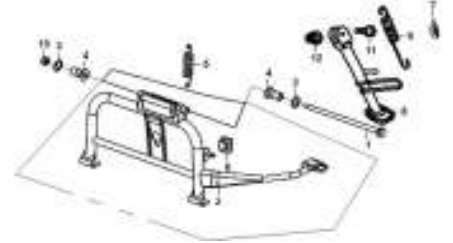

F16 Wire Harness

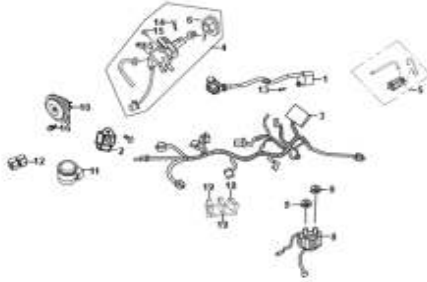

F17 Frame Body • Engine Hanger

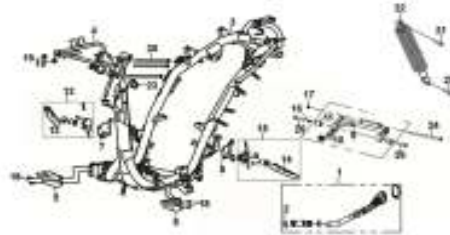

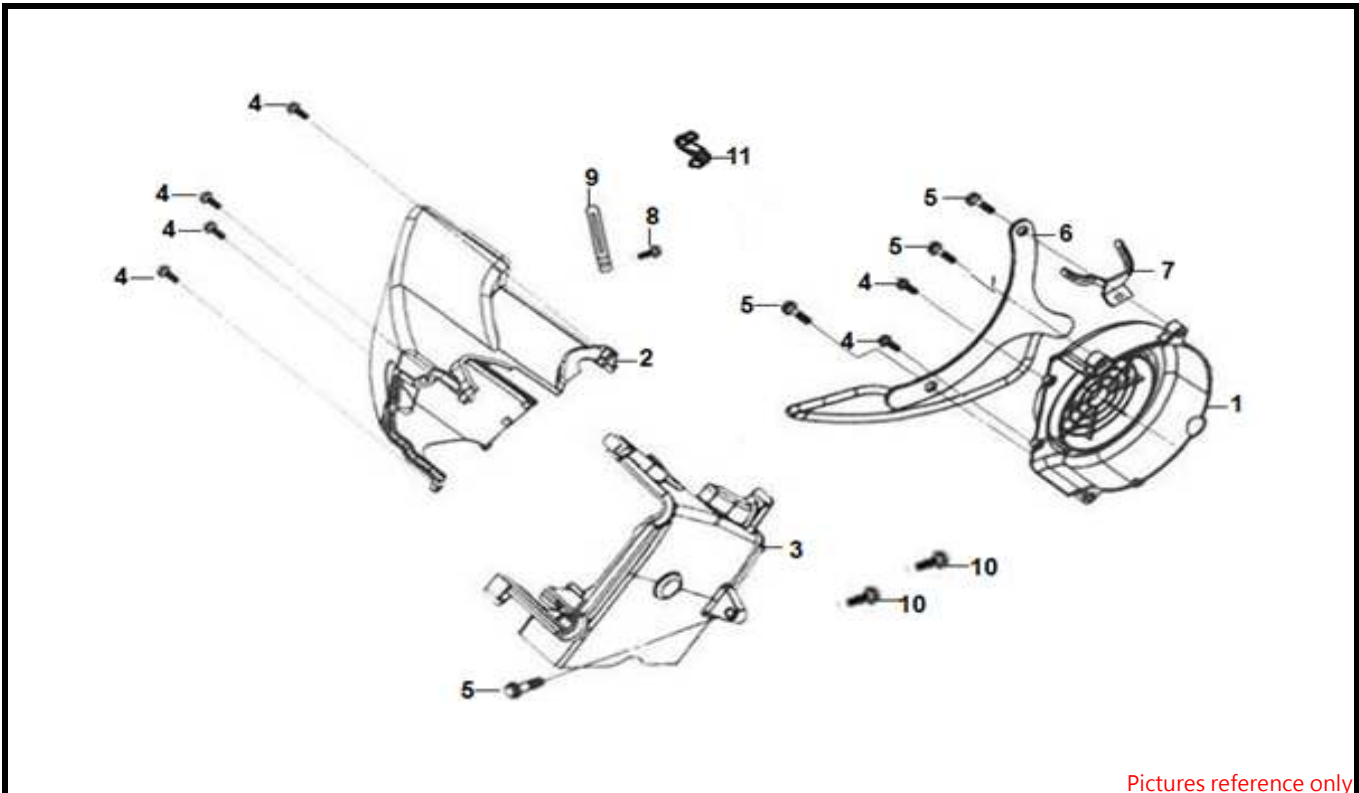

Pictures reference only

NO	PARTS NUMBER	PRICE ( RM / PCS )	DESCRIPTION	QTY	EFFECTIVE DATE
01	1961A-X8A-000	16.50	Fan cover COMP.	1	
02	1962A-X8A-000	44.30	Shroud A ASSY.	1	
03	1963A-Z7P-000	24.60	Shroud B ASSY.	1	
04	93904-35340	0.50	Tapping screw 5*16	6	
05	96001-06025-08	1.20	SH. flange bolt 6*25	4	
06	18241-F6S-000	18.20	EXH. pipe protector	1	
07	19613-GY6-900	4.10	Starter motor cord clampe	1	
08	93903-34340	1.20	Tapping screw 4*12	1	
09	94591-17000	1.50	Clip 1*70	1	
10	93904-35380	0.90	Tapping screw 5*16	2	
11	11383-GY6-A00	2.80	Breather tube clamp	1	

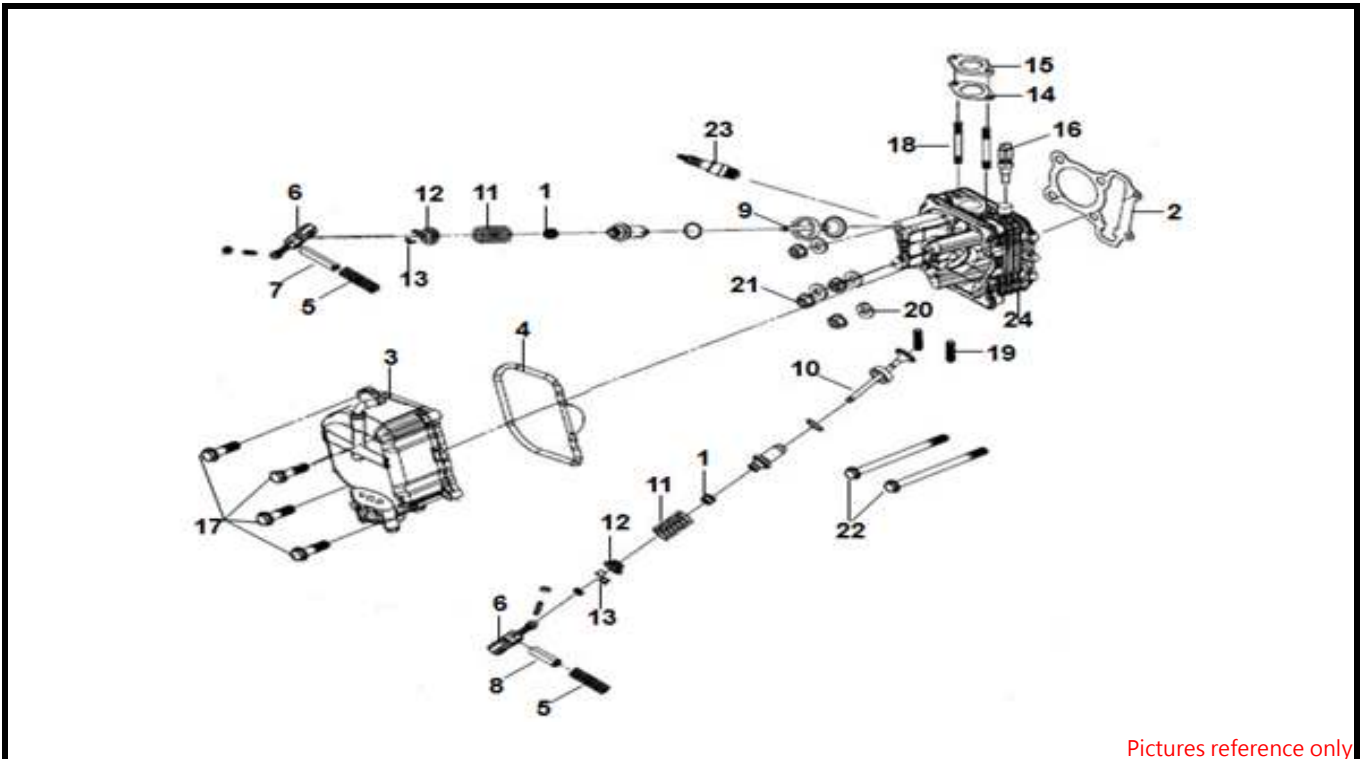

Pictures reference only

NO	PARTS NUMBER	PRICE ( RM / PCS )	DESCRIPTION	QTY	EFFECTIVE DATE
01	12209-H6B-0000	7.80	Valve stem seal	2	
02	12251-H7A-000	15.10	Cylinder head gasket	1	
03	12310-A61-000	121.90	Cylinder head cover COMP	1	
3-1	12302-ANL-000	6.50	Breather separate plate	1	
3-2	12308-ARA-000	2.80	Separate plate gasket	1	
04	12391-F8A-0001	20.10	Head cover packing	1	
05	14439-F62-010	1.90	Rocker arm torsion spring	2	
06	1443A-ANL-010	58.40	Valve rocker arm ASSY.	2	
07	14451-ANL-000	13.60	IN. rocker arm shaft	1	
08	14452-ANL-000	10.50	EXH. rocker arm shaft	1	
09	14711-F8A-000	42.50	IN. valve	1	
10	14721-F8A-000	89.70	EXH. valve	1	
11	14751-ARA-000	5.90	Valve spring	2	
12	14771-F6C-A00	7.90	Retainer valve spring	2	
13	14781-A01-A00	1.20	Valve cotter	1	
14	16201-Z2D-000	1.30	CARB. insulator gasket	2	
15	16211-ANL-010	5.90	CARB. insulator	1	
16	37880-Z5C-000-M1	143.40	CYL. head TEMP. sensor	1	
17	93903-34180	1.40	Tapping screw 4*8	4	
18	90033-M92-000	1.90	STUD bolt 6*55	2	
19	90034-HMA-000	1.50	Special STUD bolt 8*40	2	
20	90442-028-000	1.40	Sealing washer 8MM	4	
21	94050-08080	0.90	Flange nut 8MM	4	
22	96001-06095-08	1.20	Flange sh bolt 6*95	2	
23	AC-1PCR7HSA-3	19.80	PLUG. spark(NGK CR7HSA)	1	
24	1220C-XGG-000	933.10	Cylinder head ASSY	1	

CAM SHAFT&CYL. HEAD L. SIDE COVER

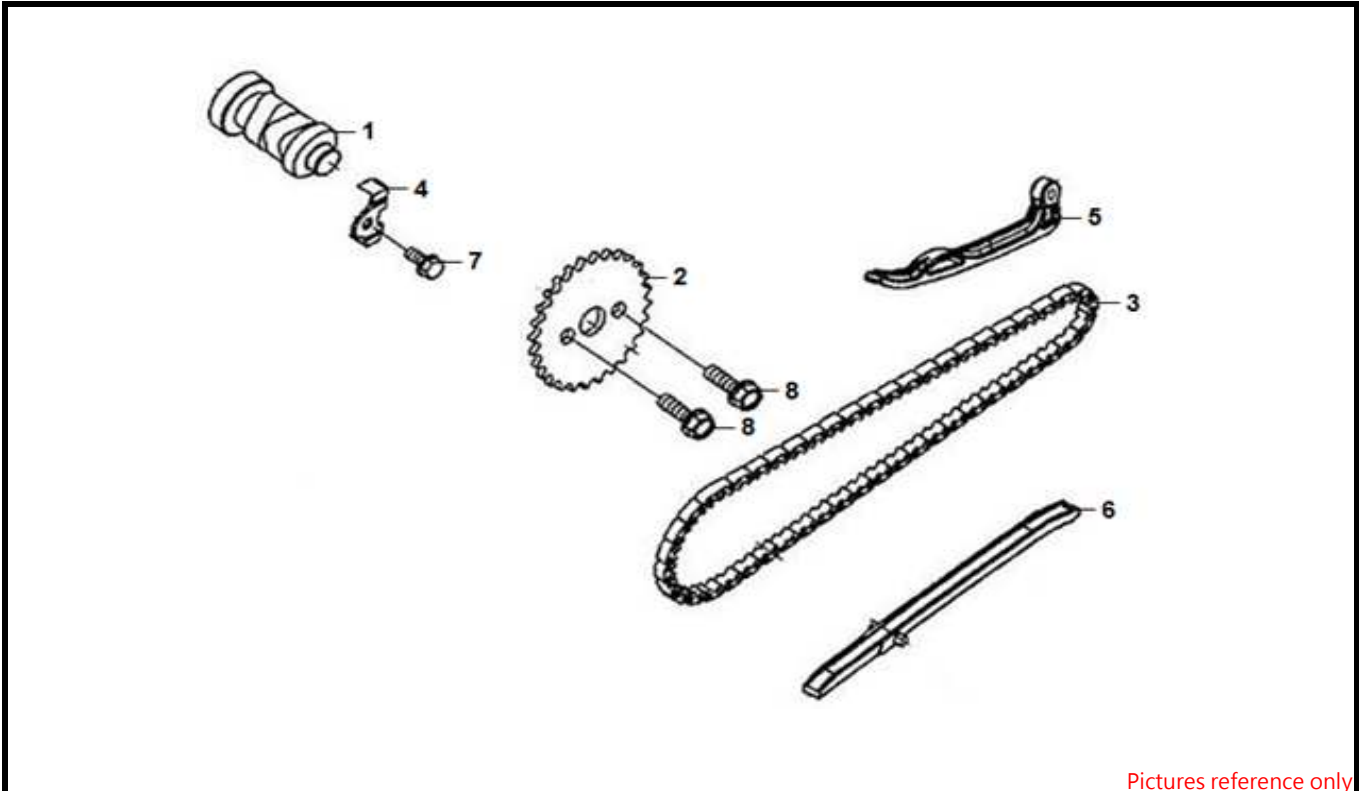

Pictures reference only

NO	PARTS NUMBER	PRICE ( RM / PCS )	DESCRIPTION	QTY	EFFECTIVE DATE
01	14100-ANL-000	134.90	Cam shaft COMP.	1	
02	14105-F6A-000	18.60	Cam sprocket	1	
03	1C14401-M92-000	73.60	Cam chain	1	
04	14457-ANL-000	3.50	Cam shaft setting plate	1	
05	14510-F8A-0001-L1	29.30	Cam chain tensioner	1	
06	14610-F8A-0001-L1	12.90	Cam chain guide	1	
07	96001-06012-04	0.50	SH. flange bolt 6*12	1	
08	90083-B12-000	0.90	Knock bolt 6MM	2	



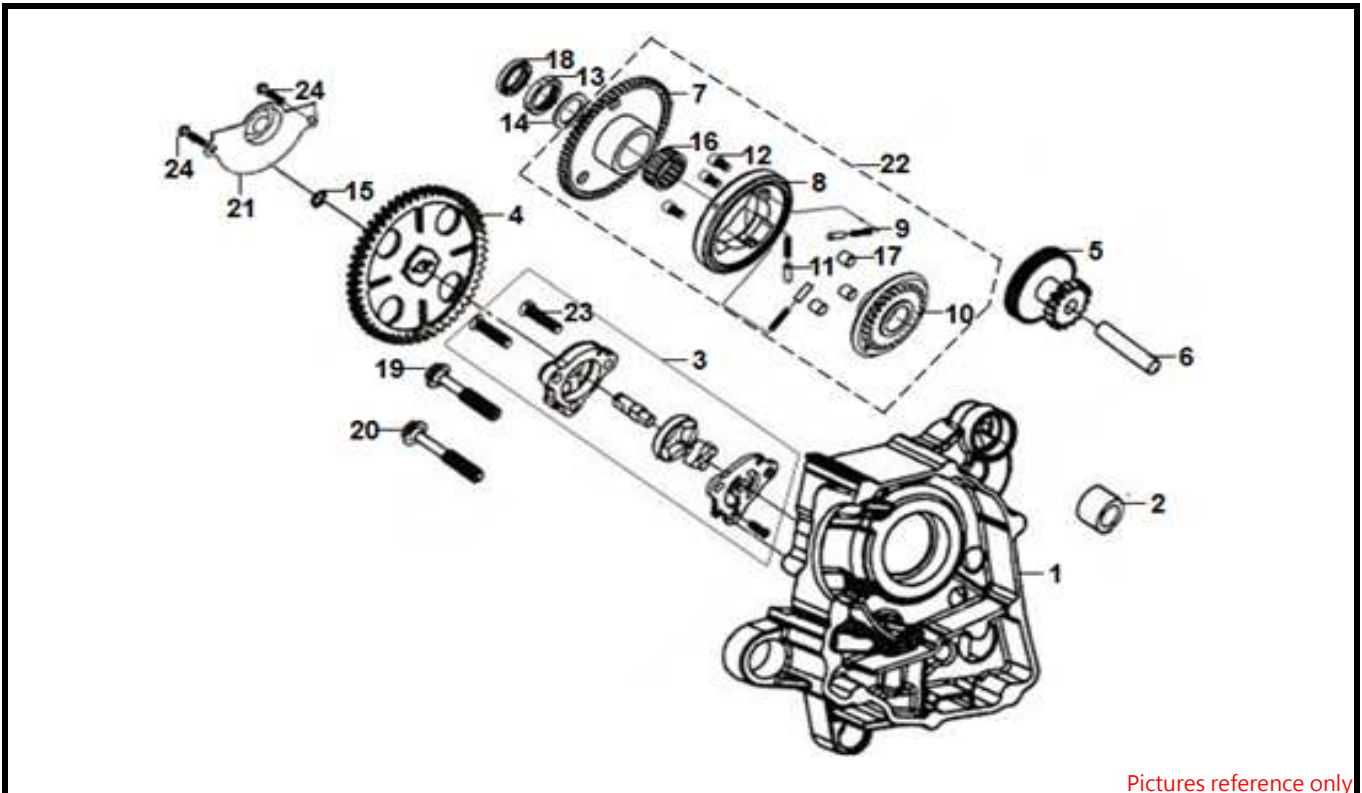

Pictures reference only

NO	PARTS NUMBER	PRICE ( RM / PCS )	DESCRIPTION	QTY	EFFECTIVE DATE
01	11100-ARA-000	257.40	R. crank case COMP.	1	
02	11102-M9Q-300	7.60	ENG. hanger rubber bush	1	
03	15100-F6C-000	60.50	Oil pump ASSY.	1	
04	15133-F6C-000	13.60	Oil pump driven gear	1	
05	28101-M9Q-000	45.80	Starter reduction gear	1	
06	28102-M9Q-000	4.50	Start. red. gear shaft	1	
07	28110-M9Q-000	73.40	Start. clutch gear COMP	1	
08	28120-M9Q-000	124.40	Starting clutch outer COMP.	1	
09	28124-H6T-000	0.40	Starter clutch roller spring	3	
10	28125-M92-000	61.50	Starting clutch flange COMP.	1	
11	28126-M9Q-000	6.50	Starting roller spring cap	3	
12	90002-M9Q-000	2.80	Socket bolt 6*10	3	
13	90201-GY6-900	5.20	Lock nut 22MM	1	
14	90403-M92-000	2.20	Thrust washer 22.2*31*1.5	1	
15	90602-N01-000	0.90	C-clip 8mm	2	
16	91104-M9Q-000	22.70	Needle bearing 28*32*17	1	
17	91105-M9Q-000	3.60	Roller 10*10	3	
18	91201-M9Q-300-M1	12.00	Oil seal 19.8*30*5R	1	
19	96001-06045-08	1.10	Flange bolt 6*45	1	
20	96001-06055-08	1.40	Flange bolt 6*55	1	
21	15711-M92-000	3.60	Oil pump separator	1	
22	2812A-H6T-000-M1	237.70	Starting clutch outer ASSY.	1	
23	93600-06025-0H	0.90	Flate screw 6*25	2	
24	96001-06012-08	0.90	SH. flange bolt 6X12	2	

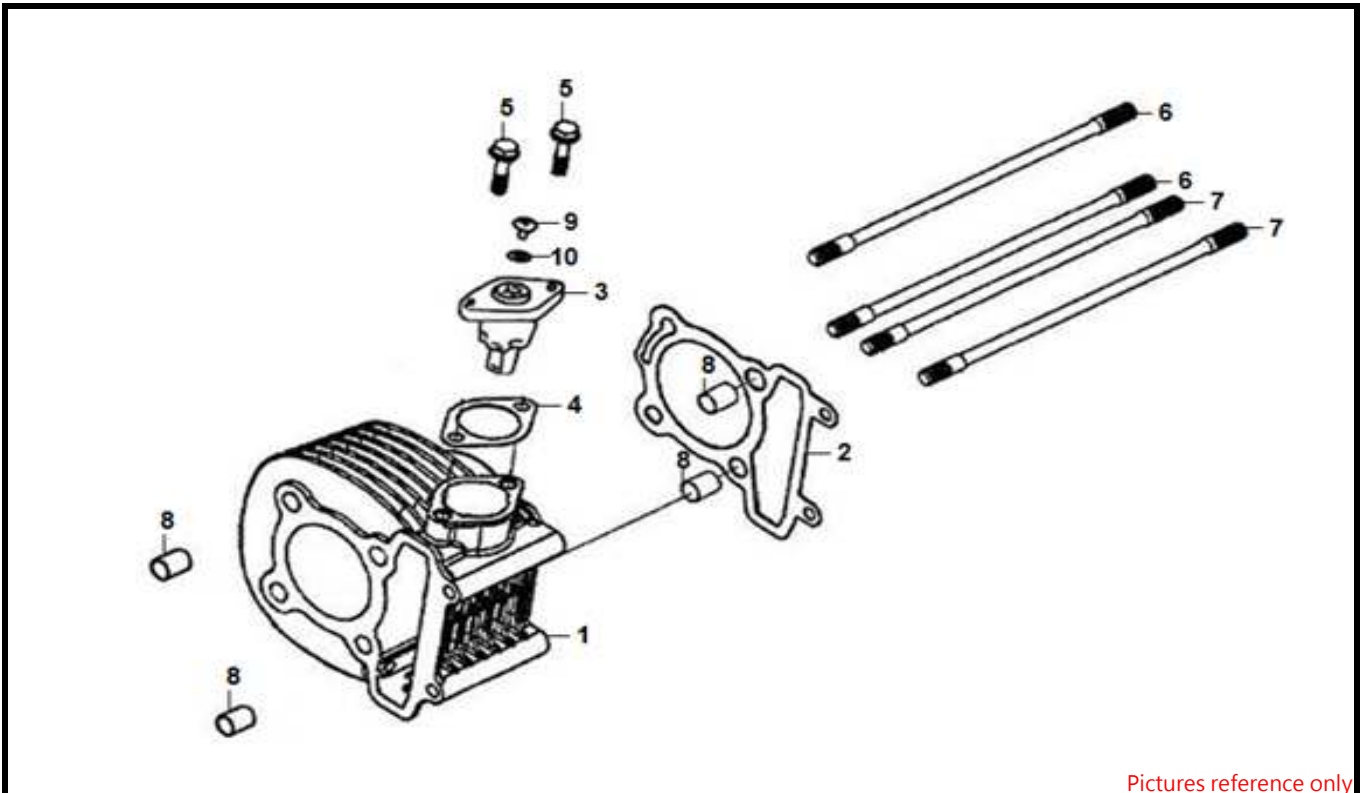

Pictures reference only

NO	PARTS NUMBER	PRICE ( RM / PCS )	DESCRIPTION	QTY	EFFECTIVE DATE
01	12100-ARA-000	314.30	Cylinder	1	
02	12191-Z2D-000	10.90	Cylinder gasket	1	
03	14520-GY6-901	67.20	Tensioner lifter ASSY.	1	
04	14523-Z8G-000	0.40	Tensioner lifter gasket	1	
05	90001-M9Q-000	0.90	SH. flange bolt 6*22	2	
06	90031-107-010	8.70	Cylinder stud bolt A	2	
07	90032-A6A-000	7.60	Cylinder stud bolt B	2	
08	90703-M8Q-000	1.10	Dowel pin 10*14	4	
09	90005-KW1-900	0.60	Pan screw 6*6	1	
10	91306-GY6-A00	1.20	O-ring 1.78*9.5	1	

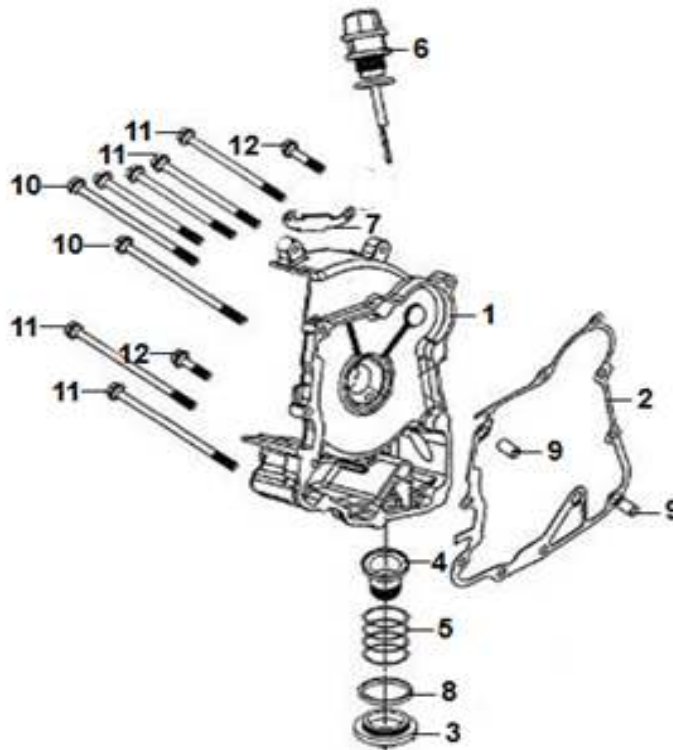

Pictures reference only

NO	PARTS NUMBER	PRICE ( RM / PCS )	DESCRIPTION	QTY	EFFECTIVE DATE
01	11331-ARB-000	150.40	R. crank case cover	1	
02	11394-Z2D-000	12.20	R. cover gasket	1	
03	12361-M9Q-0000	9.40	Tappet adjusting hole cap	1	
04	15421-H66-000	11.20	Oil filter screen	1	
05	15426-M9Q-000	0.90	Oil fillter screen SPG.	1	
06	1565A-ARA-000	8.30	Oil level gauge	1	
07	32961-ARA-000	6.10	ACG cord clammer	1	
08	91302-M9T-000	1.90	O-ring 30.8MM	1	
09	94301-08140	1.20	Dowel pin 8*14	2	
10	96001-06100-08	1.40	SH flange bolt 6*100	2	
11	96001-06095-08	1.20	Flange sh bolt 6*95	6	
12	96001-06030-08	1.10	SH. flange bolt 6*30	2	

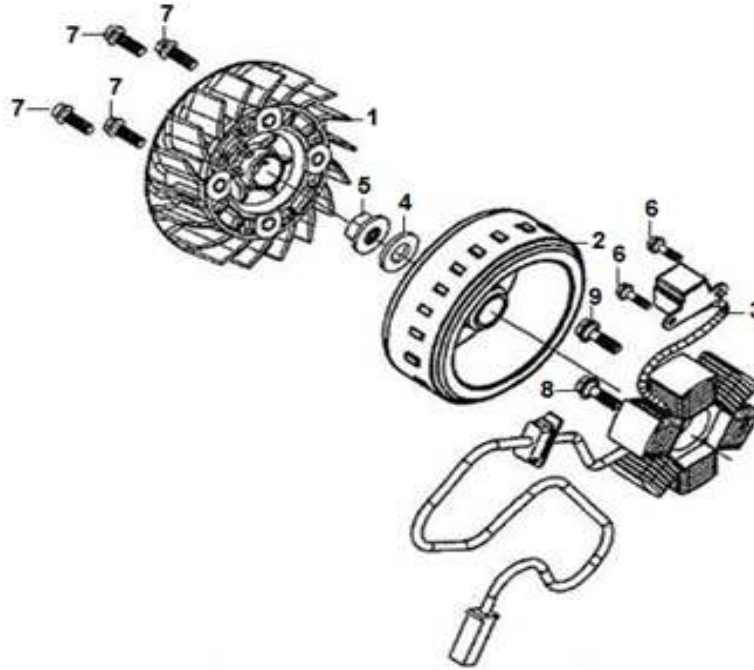

Pictures reference only

NO	PARTS NUMBER	PRICE ( RM / PCS )	DESCRIPTION	QTY	EFFECTIVE DATE
01	19510-XJ1-000	18.70	Cooling fan COMP.	1	
02	31110-F6T-000	111.20	Flywheel COMP	1	
03	31120-X8A-000	228.70	Loop COMP.	1	
04	90440-166-000	1.50	Plane gasket 12MM	1	
05	94050-12000	2.70	Flange nut 12MM	1	
06	92101-05012-0A	0.90	HEX bolt 5*12mm	2	
07	96001-06018-08	0.90	Flange bolt 6*18	4	
08	96001-06028-08	0.90	SH. flange bolt 6*28	1	
09	96001-06020-00	0.80	SH. flange bolt 6*20	1	

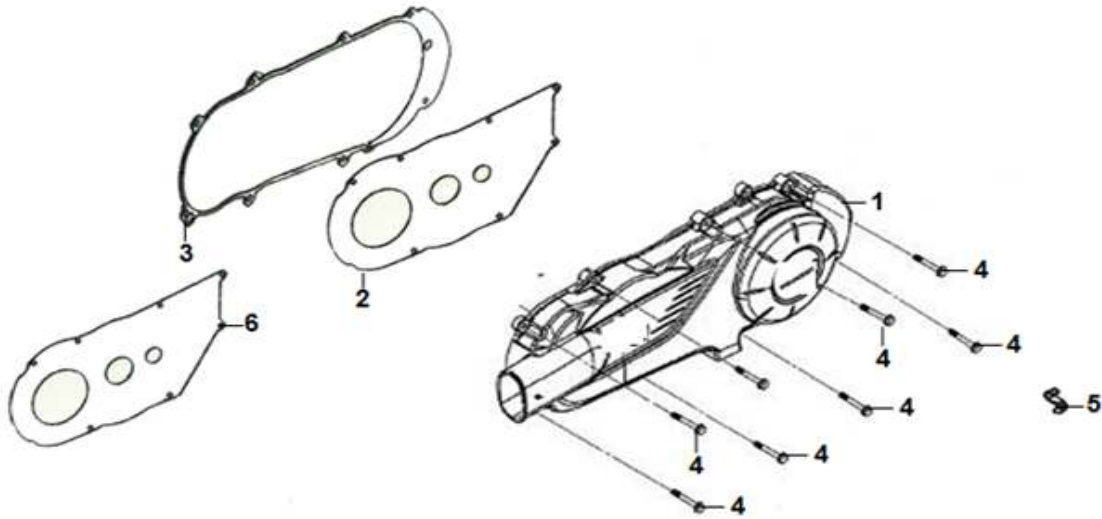

Pictures reference only

NO	PARTS NUMBER	PRICE ( RM / PCS )	DESCRIPTION	QTY	EFFECTIVE DATE
01	11341-XMA-020-K1	416.70	L. crank case cover	1	
02	11342-ARA-000	14.20	L. side cover plate	1	
03	11395-XRB-000	36.80	L. side cover gasket	1	
04	96001-06030-00	1.50	Flange bolt SH 6*30	8	
05	11382-ARB-000	1.60	Brake cable clammer B	1	
06	11343-XRB-000	19.20	L. side cover plate gasket	1	

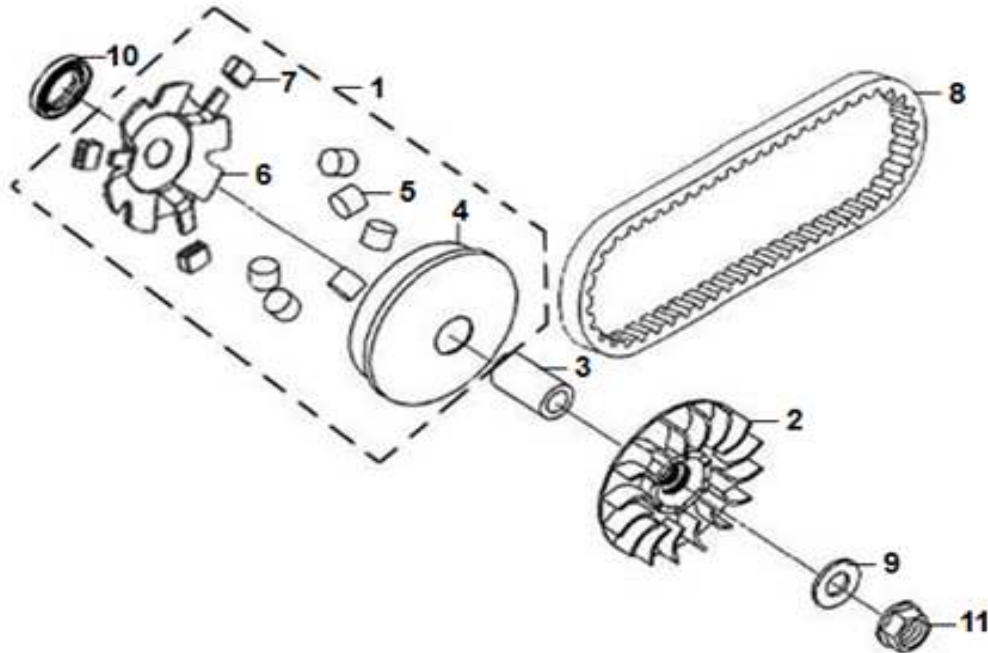

Pictures reference only

NO	PARTS NUMBER	PRICE ( RM / PCS )	DESCRIPTION	QTY	EFFECTIVE DATE
01	2211A-ARA-000	75.40	Movable drive face ASSY.	1	
02	22102-M92-000	41.90	Drive face COMP.	1	
03	22105-M92-000	20.80	Drive face bush	1	
04	22110-H5B-000	52.70	Movable drive face COMP.	1	
05	22121-HKE-000-A	29.80	Weight roller COMP.	1	
06	22131-M92-000	20.80	Ramp plate	1	
07	22132-ARA-000-A	5.60	Slide piece	1	
08	1B01A6101	183.40	Drive belt	1	
09	90440-166-000	1.50	Plane washer 12MM	1	
10	91204-HMA-000	10.60	Oil seal 25*40*7	1	
11	94050-12000	2.70	Flange nut 12MM	1	

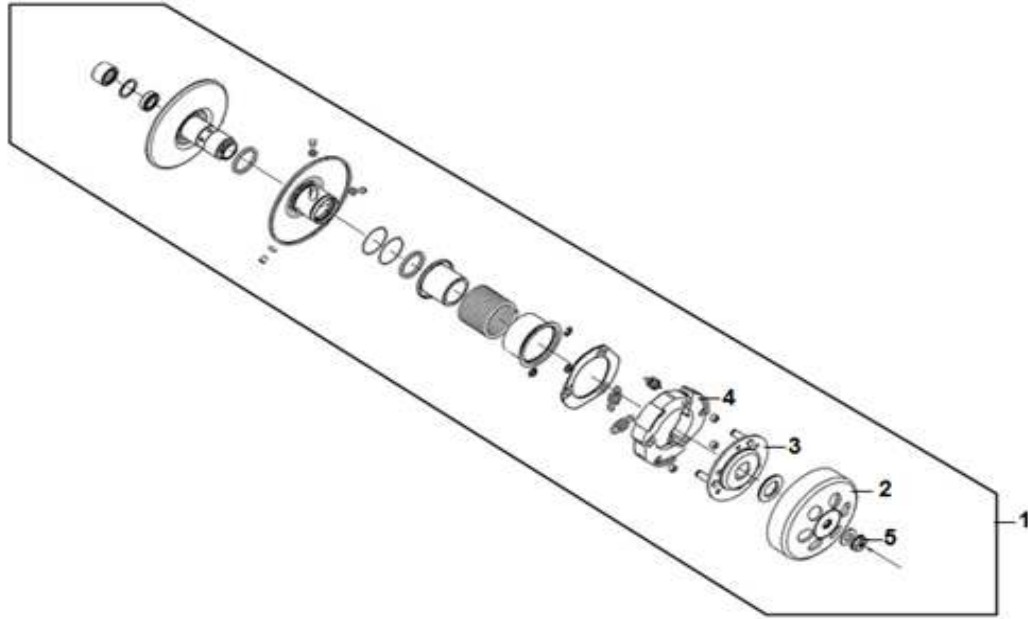

Pictures reference only

NO	PARTS NUMBER	PRICE ( RM / PCS )	DESCRIPTION	QTY	EFFECTIVE DATE
01	<b>2301A-ANT-000</b>	<b>519.60</b>	<b>Driven pulley set</b>	<b>1</b>	
02	<b>22101-F6C-000</b>	<b>97.70</b>	<b>Clutch outer</b>	<b>1</b>	
03	<b>22350-ANL-000</b>	<b>1.30</b>	<b>Drive plate COMP.</b>	<b>1</b>	
04	<b>22530-ANT-000</b>	<b>58.50</b>	<b>Clutch weight</b>	<b>1</b>	
05	<b>94050-12000</b>	<b>2.70</b>	<b>Flange nut 12MM</b>	<b>1</b>	

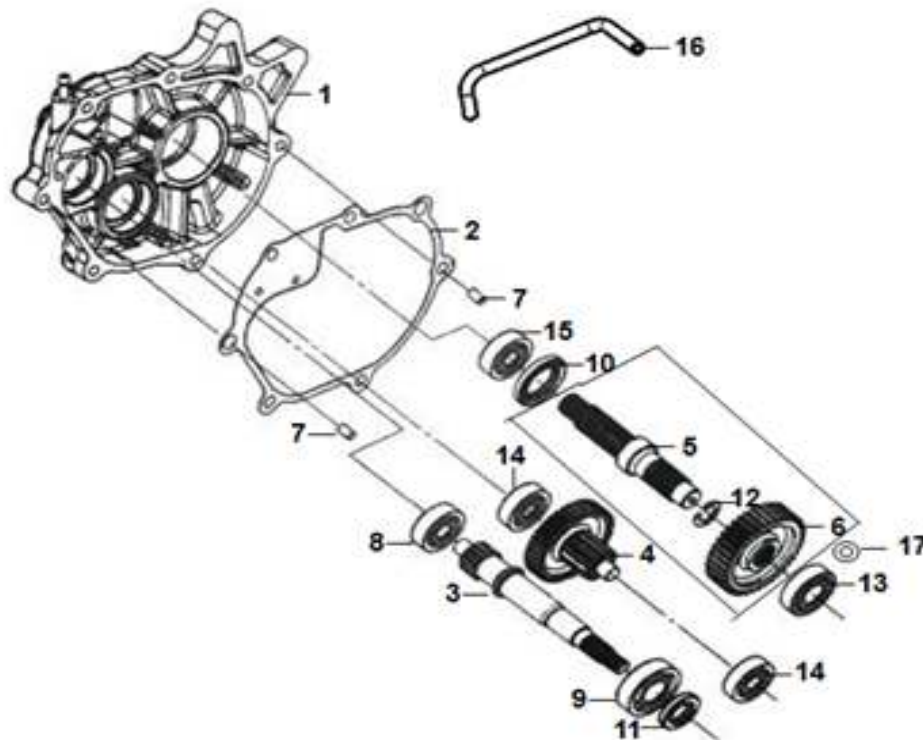

Pictures reference only

NO	PARTS NUMBER	PRICE ( RM / PCS )	DESCRIPTION	QTY	EFFECTIVE DATE
01	21200-ANM-000	204.30	Mission case COMP.	1	
02	21395-Z2D-000	13.00	Mission cover gasket	1	
03	23411-ARA-000	111.10	Drive shaft	1	
04	23420-Z7C-010	118.50	Counter shaft COMP.	1	
05	23431-ANL-000	115.80	Final shaft	1	
06	23432-AR1-000	129.20	Final gear	1	
07	90703-M8Q-000	1.10	Dowel pin 10*14	2	
08	91003-M8Q-000	37.80	Radial ball BRG. CSB301	1	
09	91104-KN7-670	60.30	Radial ball BRG. CSB204	1	
10	91203-A6A-000	6.70	Oil seal 34*52*8	1	
11	91202-KJ9-003	3.10	Oil seal 20*32*6	1	
12	94510-25000	1.50	EX. cir-clip 25MM	1	
13	96100-62030-00	10.70	Radial ball BRG. 6203	1	
14	96100-63013-00	13.50	Radial ball BRG 6301	2	
15	96150-62050-10	30.30	Ball radial bearing 6205	1	
16	11221-ARA-000	5.90	Mission breather tube	1	
17	90401-ANL-000	3.10	Washer 17*30*1	1	



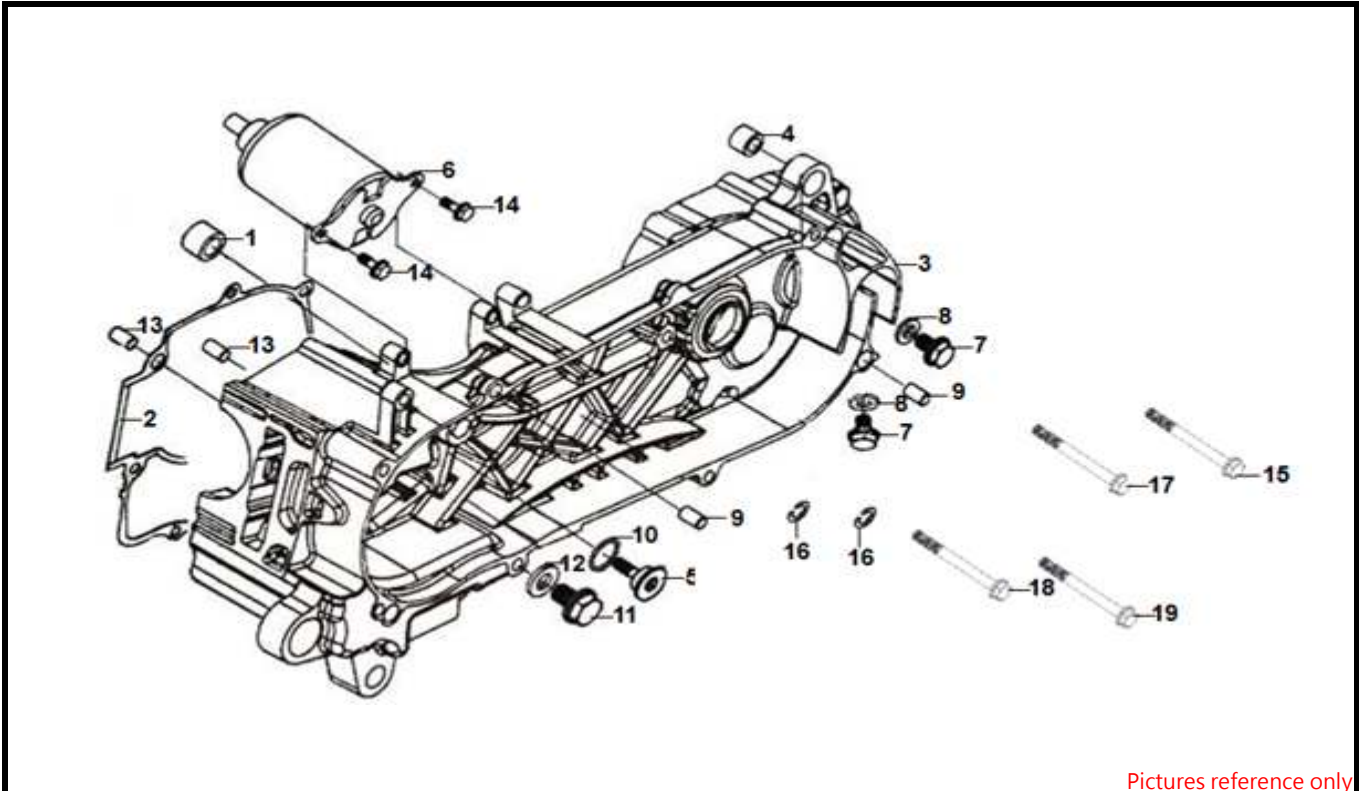

Pictures reference only

NO	PARTS NUMBER	PRICE ( RM / PCS )	DESCRIPTION	QTY	EFFECTIVE DATE
01	11102-M9Q-300	7.60	ENG. hanger rubber bush	1	
02	11192-XRB-000	15.00	R. crank case gasket	1	
03	11200-ARA-000	682.40	L. crank case COMP.	1	
04	11203-M9Q-300	3.70	RR. CUSH. UN. rubber bush	1	
05	14531-M9Q-000	6.10	Cam chain tensioner pivot	1	
06	31200-ARA-000	152.40	Start motor ASSY.	1	
07	90103-KN8-000	1.20	Special bolt 8MM	2	
08	90474-333-000	5.50	Washer 8MM	2	
09	90703-M8Q-000	1.10	Dowel pin 10*14	2	
10	91301-GR0-003	1.20	O-ring 15.2*1.5	1	
11	92800-12000	3.00	Drain plug bolt 12MM	1	
12	94109-12000	1.10	Plug drain bolt washer 12mm	1	
13	94301-08140	1.20	Dowel pin 8*14	4	
14	96001-06016-08	1.20	SH. flange bolt 6*16	2	
15	95701-08068-00	2.10	Flange bolt 8*68	1	
16	94591-28000	1.80	Clip 2*80	2	
17	95701-08055-00	1.10	Flange bolt 8*55	2	
18	95701-08060-00	1.90	SH. flange bolt 8*60	1	
19	95701-08065-00	2.10	Flange bolt 8*65	3	

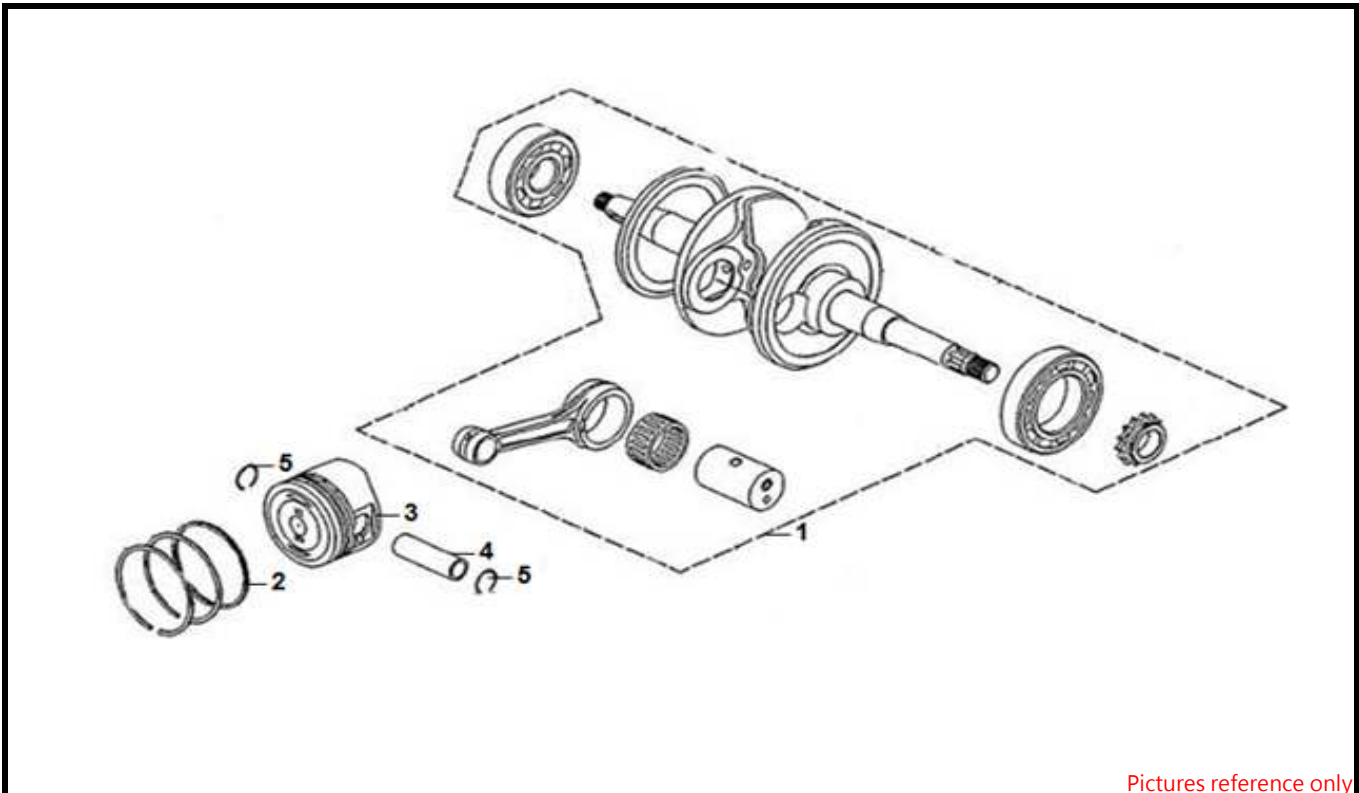

Pictures reference only

NO	PARTS NUMBER	PRICE ( RM / PCS )	DESCRIPTION	QTY	EFFECTIVE DATE
01	<b>13000-ANL-000</b>	<b>597.80</b>	<b>Crank shaft COMP</b>	<b>1</b>	
02	<b>13010-U3A-000</b>	<b>52.10</b>	<b>Piston ring set</b>	<b>1</b>	
03	<b>13101-ANL-000</b>	<b>69.40</b>	<b>Piston</b>	<b>1</b>	
04	<b>13111-ARA-000</b>	<b>7.70</b>	<b>Piston pin</b>	<b>1</b>	
05	<b>94601-15000-00</b>	<b>0.40</b>	<b>Piston pin clip</b>	<b>2</b>	

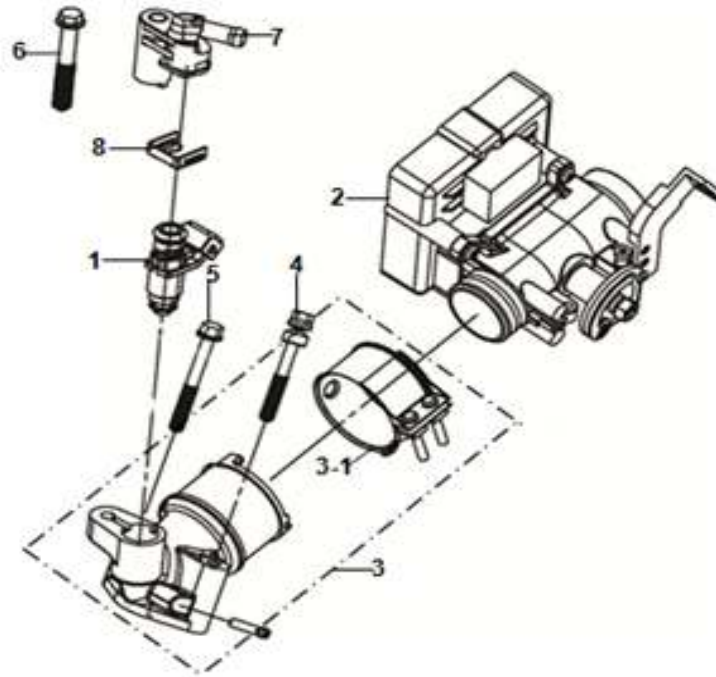

Pictures reference only

NO	PARTS NUMBER	PRICE ( RM / PCS )	DESCRIPTION	QTY	EFFECTIVE DATE
01	06414-HKK-000	291.60	Fuel injector	1	
02	1640A-XRB-010	1469.70	ECU set	1	
03	1711A-Z7P-000	129.50	Inlet pipe ASSY.	1	
3-1	17256-MA1-000	19.20	Insulator band	1	
04	90085-HHA-900	2.10	Self locking bolt 6*50	1	
05	96001-06050-02	1.90	SH. flange bolt 6*50	1	
06	96001-06045-00	1.20	SH. flange bolt 6*45	1	
07	17120-XJA-000	7.60	Fuel injector cap ASSY.	1	
08	17121-H6Y-000	2.70	Fuel injector cap clip	1	

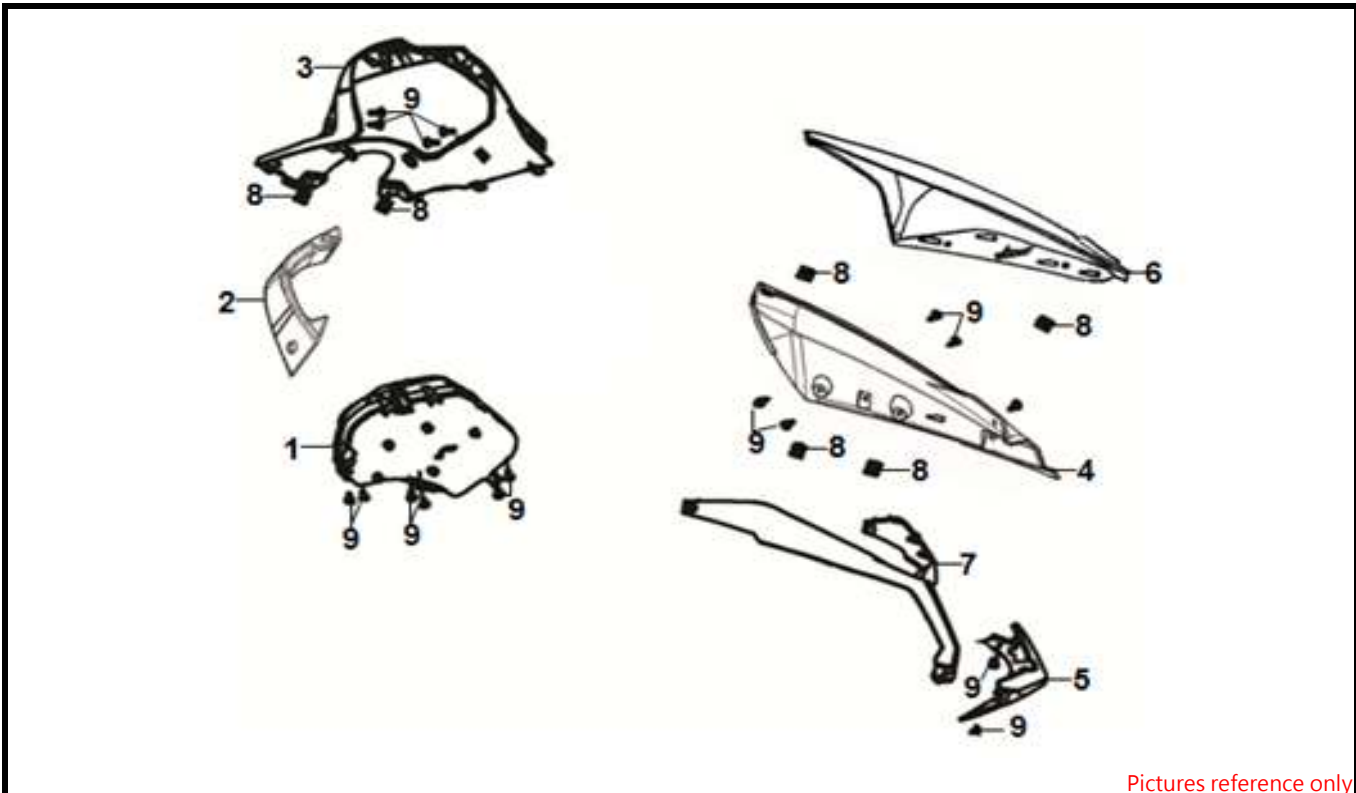

Pictures reference only

NO	PARTS NUMBER	PRICE ( RM / PCS )	DESCRIPTION	QTY	EFFECTIVE DATE
01	37200-X8A-010	486.20	Speedmeter ASSY	1	
02	53206-X8A-000	61.90	Handle down cover B	1	
03	53208-X9B-000	30.10	Meter panel	1	
04	53209-X9B-000	24.20	Meter visor	1	
05	64303-X8A-000	4.50	Head light low cover	1	
06	67100-X8A-000	105.60	Wind screen	1	
07	67110-X8A-000-AE	74.00	Wind screen garnish	1	
08	90302-SA4-900	0.60	Spring nut 4mm	6	
09	93903-35240	0.60	Tapping screw 5*12	21	

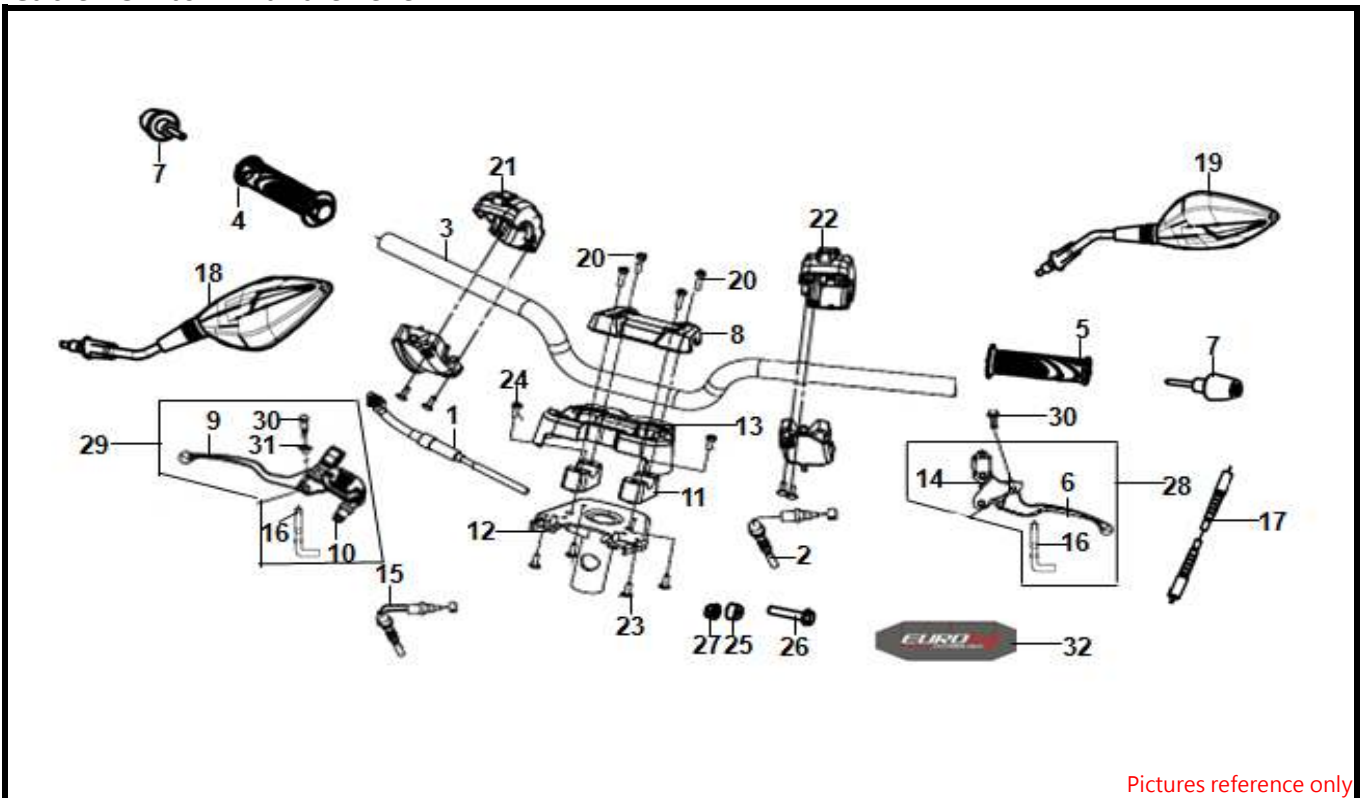

Pictures reference only

NO	PARTS NUMBER	PRICE ( RM / PCS )	DESCRIPTION	QTY	EFFECTIVE DATE
01	17910-X8A-000	37.30	Throt cable COMP	1	
02	43450-X8A-000	54.60	RR. brake cable COMP	1	
03	53100-X8A-000	81.80	STRG. handle	1	
04	53140-XPA-0001-VN	13.15	RH. HNDL. grip	1	
05	53166-XPA-0001-VN	8.30	LH. HNDL. grip	1	
06	53178-ATA-000	21.20	L. STRG. handle lever	1	
07	53104-AWR-000	46.30	Handle pipe WT.	2	
08	53131-AWU-000-KH	63.50	HNDL. pipe up. holder	1	
09	53175-ANT-000	18.80	R. strg. handle lever	1	
10	53182-X8A-000	30.10	R. HNDL. BRKT.	1	
11	53132-AWU-000	34.70	Handle pipe down hodler	2	
12	53231-X8A-000	76.70	Handle pipe holder COMP	1	
13	53205-X8A-000	76.60	handle down cover	1	
14	53192-X8A-000	30.10	L. HNDL. BRKT.	1	
15	45450-X8A-000	20.50	FR. brake cable	1	
16	35340-M92-900	9.30	Stop SW. ASSY	2	
17	44830-X8A-000	23.70	Speedometer cable COMP	1	
18	88110-XPA-000-K	60.50	R. RR. back mirror	1	
19	88120-XPA-000-K	60.50	L. back mirror	4	
20	96700-06025-49	5.60	Socket bolt 6*25	1	
21	35150-X8A-000	70.30	R. handle SW.	1	
22	35200-X8A-000	100.40	L. handle SW. UNIT	4	
23	93903-45340	0.90	Tapping screw 5*16	2	
24	96700-08020-02	1.60	Socket bolt 8*20	1	
25	53125-CT1C-A00	9.60	HNDL. set collar	1	

26	<b>90106-AAA-000</b>	<b>3.60</b>	<b>FR. disk bolt</b>	<b>1</b>
27	<b>90304-AAA-000</b>	<b>2.20</b>	<b>Flange. u nut 10mm</b>	<b>1</b>
28	<b>5318A-X8A-000</b>	<b>68.40</b>	<b>L .STRG.handle lever ASSY</b>	<b>1</b>
29	<b>5319A-X8A-000</b>	<b>68.40</b>	<b>R.STRG.handle lever ASSY</b>	<b>1</b>
30	<b>90115-AWU-000</b>	<b>5.60</b>	<b>Screw handle lever pivot</b>	<b>1</b>
31	<b>53181-ANT-000</b>	<b>1.50</b>	<b>R. brake lever return spring</b>	<b>1</b>
32	<b>87170-X8B-000</b>	<b>1.30</b>	<b>Handle holder emblem</b>	<b>1</b>

●Please check the color & stripe information according to the color index !

Mar-18

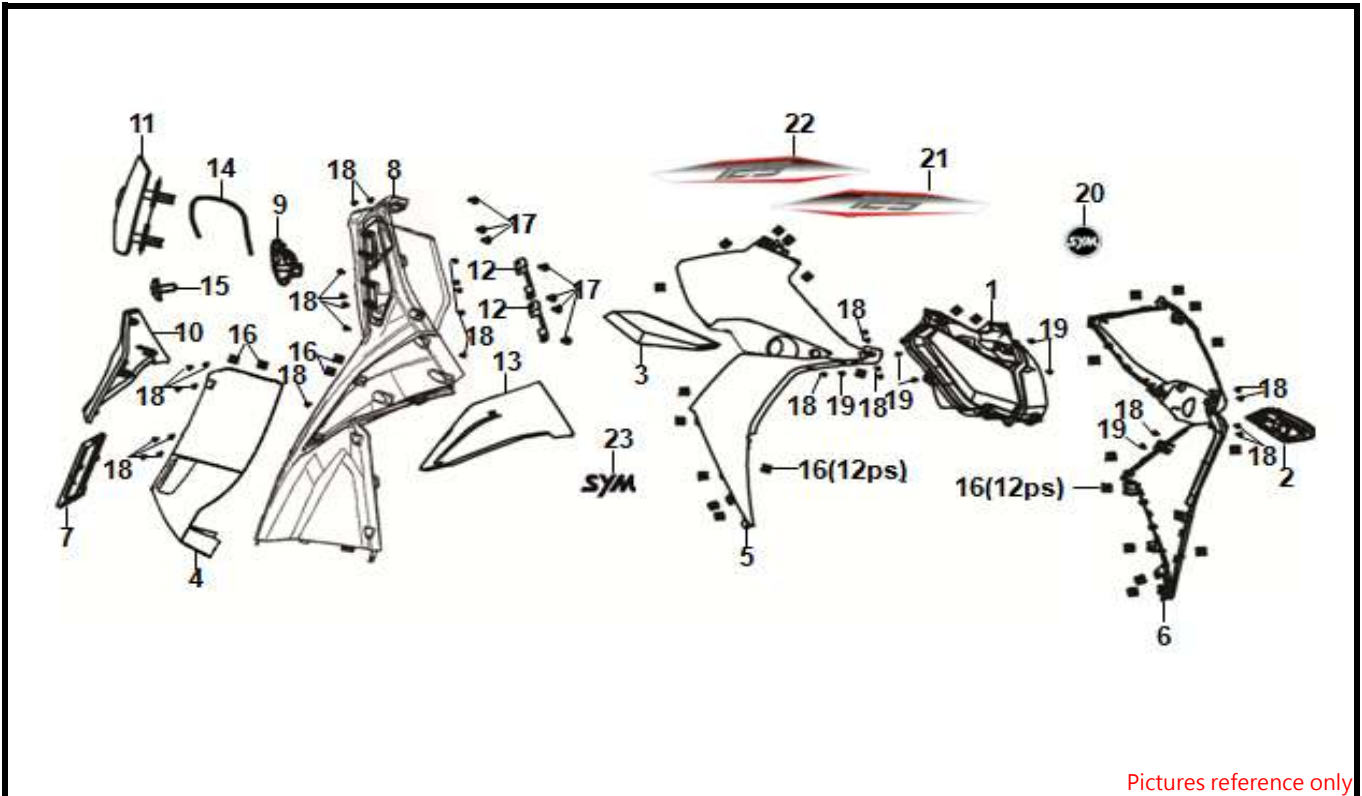

Pictures reference only

NO	PARTS NUMBER	PRICE ( RM / PCS )	DESCRIPTION	QTY	EFFECTIVE DATE
01	33100-X8A-000	786.80	Head light ASSY.	1	
02	33450-X8A-000	74.40	FR. L. winker ASSY	1	
03	33400-X8A-000	74.40	FR. R. winker ASSY	1	
04	64300-X8A-000	82.50	FR. UND. cover	1	
05	64302-X8A-000-RD	223.60	L FR. COVER(R-010CA)	1	
05	64302-X8A-000-BP	223.60	L FR. COVER(BU-289S)	1	
05	64302-X8A-000-WA	223.60	L FR. COVER(WH-006)	1	
06	64301-X8A-000-RD	223.60	R FR. COVER(R-010CA)	1	
06	64301-X8A-000-BP	223.60	R FR. COVER(BU-289S)	1	
06	64301-X8A-000-WA	223.60	R FR. COVER(WH-006)	1	
07	64318-ALA-000-BK	4.80	Frame number lid	1	
08	81131-X8A-900	133.90	Inner box	1	
09	81132-X8A-000	4.10	Luggage hook	1	
10	81133-X8A-000-AE	60.10	RH. Inner box garnish	1	
11	81141-X8A-000	9.50	Inner box lid	1	
12	81142-X8A-000	2.80	Inner box lid garnish	2	
13	81143-X8A-000-AE	60.10	LH. Inner box garnish	1	
14	81146-X8A-000	2.00	Inner box seal	1	
15	90118-B9A-000	3.00	Washer screw 5x14	1	
16	90302-SA4-900	0.60	Spring nut 4mm	30	
17	93903-34340	1.20	Tapping screw 4*12	7	
18	93903-35240	0.60	Tapping screw 5*12	30	
19	93903-35340	0.30	Tapping screw 5*16	6	
20	87552-L6G-900	35.90	FR. cover lid emblem	1	
21	87123-X8B-000-T1	8.90	R.FR cover stripe(WHITE)	1	

21	<b>87123-X8B-000-T2</b>	<b>8.90</b>	<b>R.FR cover stripe(RED)</b>	<b>1</b>
22	<b>87124-X8B-000-T1</b>	<b>8.90</b>	<b>L.FR cover stripe(WHITE)</b>	<b>1</b>
22	<b>87124-X8B-000-T2</b>	<b>8.90</b>	<b>L.FR cover stripe(RED)</b>	<b>1</b>
23	<b>87170-U11-000-T1</b>	<b>1.90</b>	<b>SYM stripe(BLACK)</b>	<b>2</b>
23	<b>87170-U11-000-T2</b>	<b>1.90</b>	<b>SYM stripe(WHITE)</b>	<b>2</b>

●Please check the color & stripe information according to the color index !

Mar-18



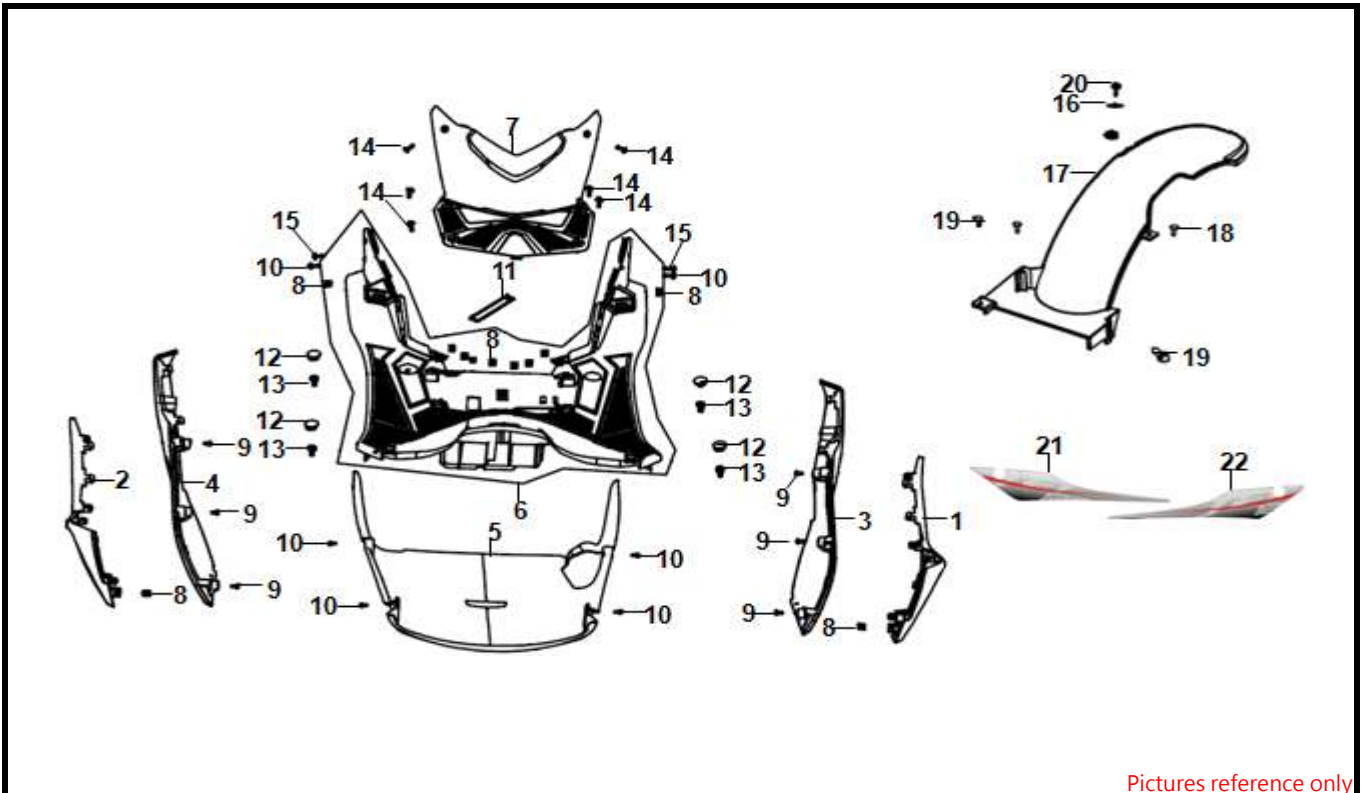

Pictures reference only

NO	PARTS NUMBER	PRICE ( RM / PCS )	DESCRIPTION	QTY	EFFECTIVE DATE
01	83520-X8A-000	15.00	RH. FR. side cover	1	
02	83620-X8A-000	15.00	LH. FR. side cover	1	
03	83530-X8A-000-AE	90.10	RH. RR. side cover	1	
04	83630-X8A-000-AE	90.10	LH. RR. side cover	1	
05	50611-APA-000	72.80	Under cover	1	
06	64310-X8A-000	120.20	Floor panel	1	
07	50326-X8A-000	25.00	Battery cover	1	
08	90302-SA4-900	0.60	Spring nut 4mm	11	
09	93903-35240	0.60	Tapping screw 5*12	6	
10	93404-06016-00	0.90	Washer bolt 6*16	6	
11	50324-X8A-000	14.40	Battery band	1	
12	50612-APA-000	3.50	FLOOR STEP CAP A	4	
13	90111-AAA-000	1.90	Flange bolt 6mm (GREEN)	4	
14	93903-45240	2.20	Tapping screw 5*12	6	
15	90118-B9A-000	3.00	Washer screw 5x14	2	
16	64306-X01-000	1.20	Collar	1	
17	80105-X8A-000	32.80	RR. mudguard	1	
19	95701-06012-04	0.50	Flange bolt 6*12	4	
20	95801-06022-04	1.90	Flange bolt 6*22	1	
21	87131-X8B-000-T1	10.90	R. side cover stripe(RED)	1	
21	87131-X8B-000-T2	10.90	R. side cover stripe(BULE)	1	
21	87131-X8B-000-T3	10.90	R. side cover stripe(GRAY)	1	
22	87132-X8B-000-T1	10.90	L. side cover stripe(RED)	1	
22	87132-X8B-000-T2	10.90	L. side cover stripe(BULE)	1	
22	87132-X8B-000-T3	10.90	L. side cover stripe(GRAY)	1	

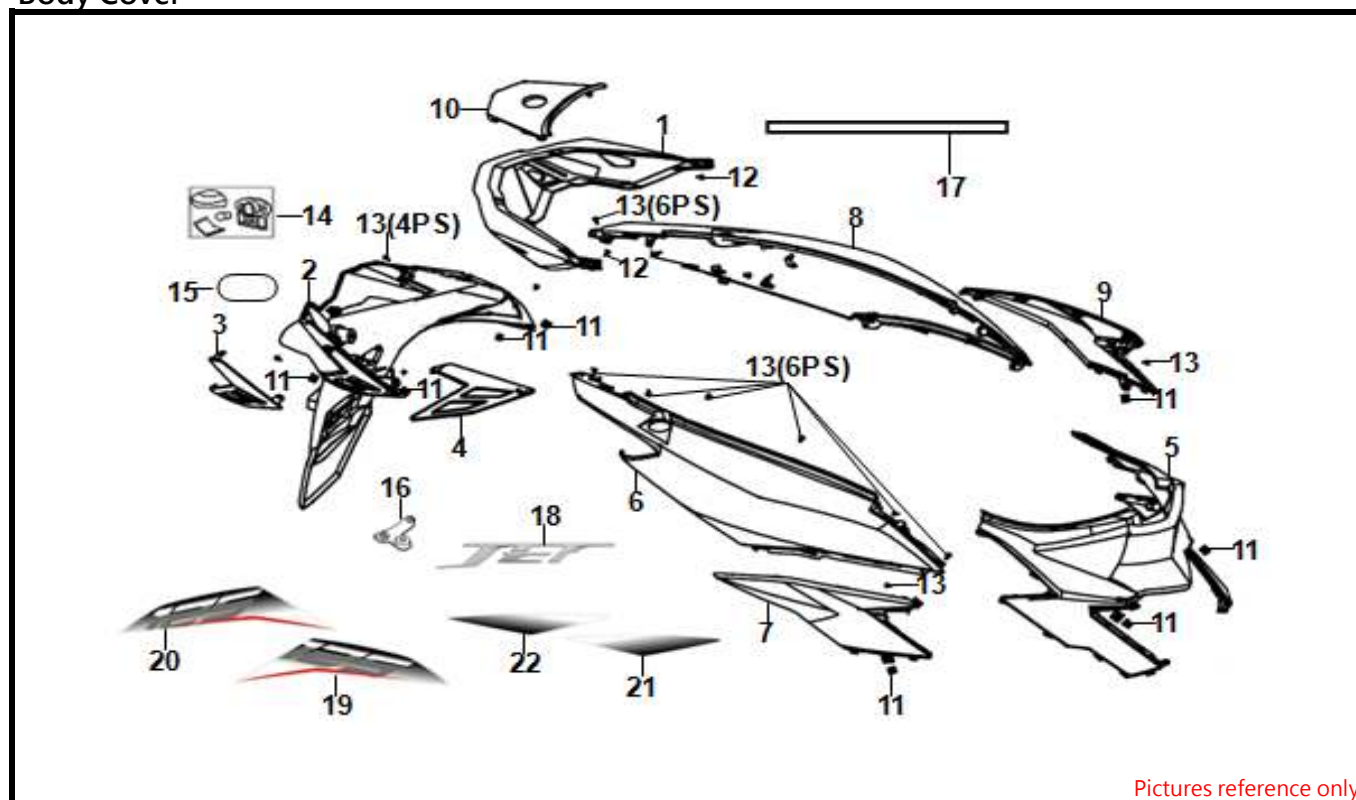

Pictures reference only

NO	PARTS NUMBER	PRICE ( RM / PCS )	DESCRIPTION	QTY	EFFECTIVE DATE
01	33700-X8A-000	465.80	Tail light ASSY	1	
01-1	33701-X8A-000	73.80	Tail light lens	1	
02	80100-X8A-000	65.90	RR. fender	1	
03	80107-X8A-000	49.60	RH. RR. fender garnish	1	
04	80108-X8A-000	49.60	LH. RR. fender garnish	1	
05	80151-X8A-000	46.50	Center cover	1	
06	83500-X8A-000-RD	212.10	R BODY COVER(R-010CA)	1	
06	83500-X8A-000-BP	212.10	R BODY COVER(BU-289S)	1	
06	83500-X8A-000-WA	212.10	R BODY COVER(WH-006)	1	
07	83510-X8A-000-AE	98.60	R. Body lower cover	1	
08	83600-X8A-000-RD	212.10	L BODY COVER(R-010CA)	1	
08	83600-X8A-000-BP	212.10	L BODY COVER(BU-289S)	1	
08	83600-X8A-000-WA	212.10	L BODY COVER(WH-006)	1	
09	83610-X8A-000-AE	98.60	L. Body lower cover	1	
10	83650-X8A-000-RD	79.70	RR center cover(R-010CA)	1	
10	83650-X8A-000-BP	79.70	RR center cover(BU-289S)	1	
10	83650-X8A-000-WA	79.70	RR center cover(WH-006)	1	
11	90302-SA4-900	0.60	Spring nut 4mm	8	
12	93903-34340	1.20	Tapping screw 4*12	2	
13	93903-35240	0.60	Tapping screw 5*12	18	
14	33740-Z6A-000	22.30	License light	1	
15	33741-N7B-E10	7.00	RR. reflector	1	
16	80106-ARA-000	8.40	RR. Mudguard plate	1	
17	80103-ARA-000	1.00	Body cover rubber	1	
18	87128-X8B-000	28.70	Body cover emblem	2	

19	<b>87125-X8B-000-T1</b>	<b>17.70</b>	<b>R. FR.body cover stripe B(WHITE)</b>	<b>1</b>
19	<b>87125-X8B-000-T2</b>	<b>17.70</b>	<b>R. FR.body cover stripe B(RED)</b>	<b>1</b>
20	<b>87126-X8B-000-T1</b>	<b>17.70</b>	<b>L. FR.body cover stripe B(WHITE)</b>	<b>1</b>
20	<b>87126-X8B-000-T2</b>	<b>17.70</b>	<b>L. FR.body cover stripe B(RED)</b>	<b>1</b>
21	<b>87129-X8B-000</b>	<b>8.20</b>	<b>R.body cover stripe B</b>	<b>1</b>
22	<b>87130-X8B-000</b>	<b>8.20</b>	<b>L body cover stripe B</b>	<b>1</b>

● Please check the color & stripe information according to the color index !

Mar-18

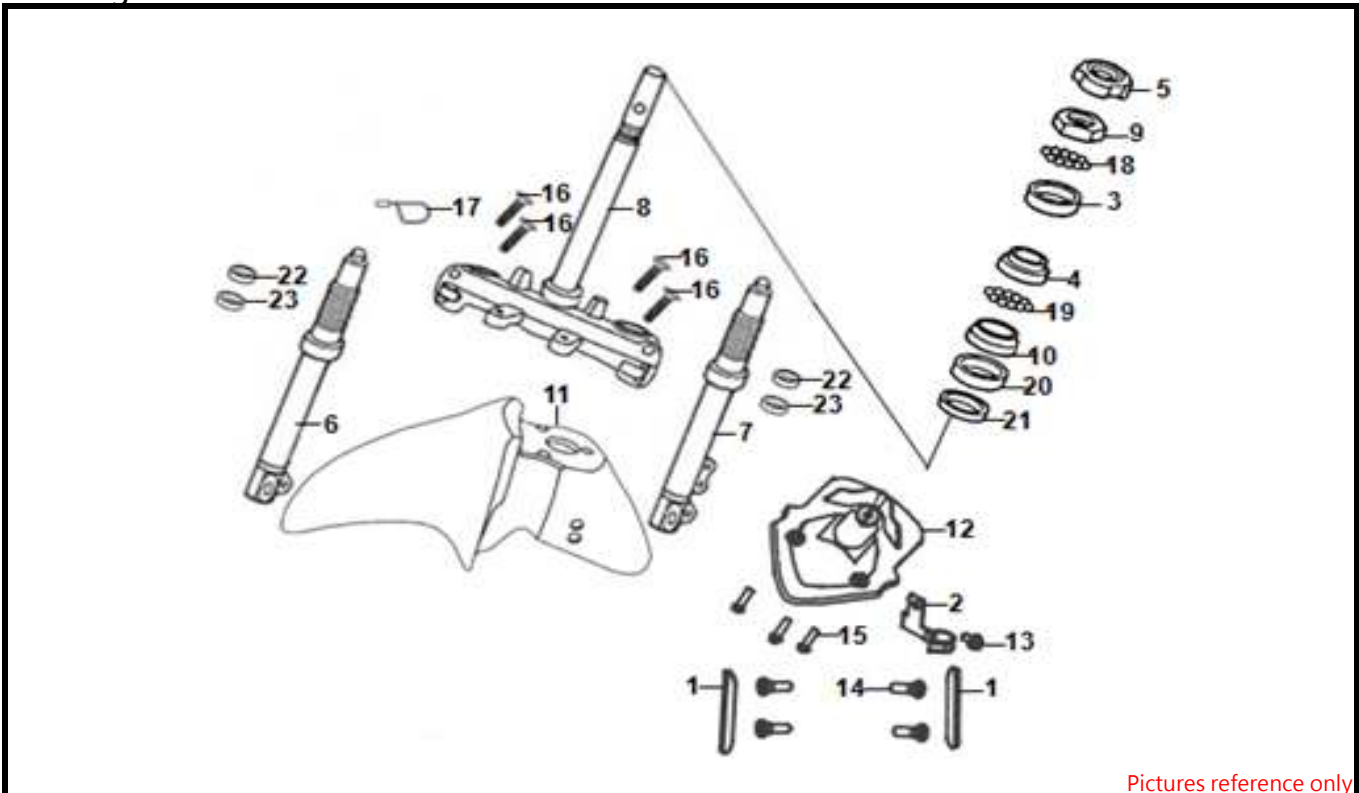

Pictures reference only

NO	PARTS NUMBER	PRICE ( RM / PCS )	DESCRIPTION	QTY	EFFECTIVE DATE
01	33742-X8A-000	7.10	Side reflector	2	
02	45156-AAA-000	5.90	FR brake hose clamp	1	
03	50301-M9Q-000	10.70	STRG. up race ball	1	
04	50302-M9Q-000	10.70	Ball race	1	
05	50306-M9Q-000	5.80	STRG. stem lock nut	1	
06	51400-X8A-000-K	295.00	FR. RH. cushion ASSY	1	
07	51500-X8A-000-K	295.00	FR. LH. cushion ASSY	1	
08	53200-X8A-000	231.00	Steering stem COMP	1	
09	53211-M9Q-0000	6.90	STRG. top cone race	1	
10	53212-M9Q-000	12.70	Race cone	1	
11	61100-X8A-000-K	186.00	FR. fender	1	
12	61110-X8A-000	9.10	FR. inner mudguard	1	
13	90115-ATA-000	2.00	Flange bolt 6*16	1	
14	90164-AAA-000	2.80	Special screw 6mm (GREEN)	4	
15	95801-06014-07	0.60	Flange bolt 6X14	3	
16	95801-08040-00	1.60	Flange bolt 8X40	4	
17	45465-ZDA-000	4.00	Cable guide	1	
18	50303-AAA-000	18.00	Up steel balls and retainer ASSY	1	
19	50304-AAA-000	18.00	Lower steel balls and retainer ASSY	1	
20	53214-M9Q-0000	1.10	STRG. head dust seal	1	
21	53215-M9Q-0000	1.10	STRG. head dust seal washer	1	
22	51403-APA-000	18.70	Oil seal	2	
23	51404-APA-000	9.20	Dust seal	2	

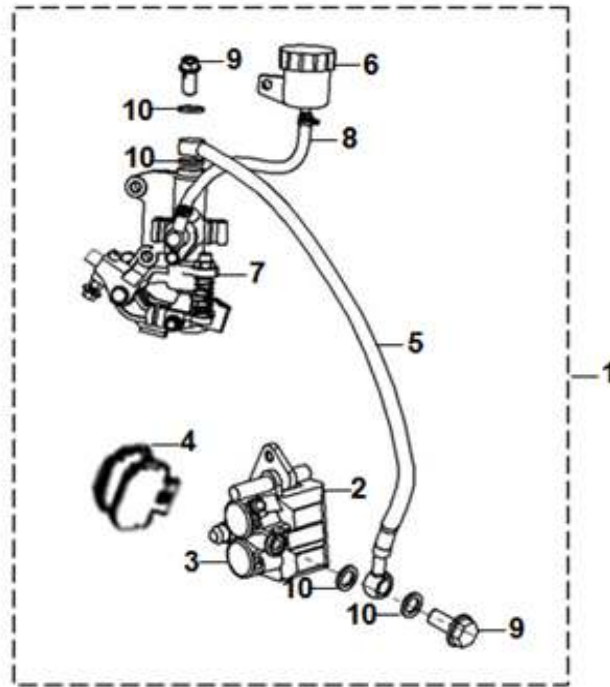

Pictures reference only

NO	PARTS NUMBER	PRICE ( RM / PCS )	DESCRIPTION	QTY	EFFECTIVE DATE
01	4500A-X8A-000	680.50	Brake system ASSY	1	
02	45100-XMC-000-K	305.60	FR. caliper ASSY	1	
03	45101-XMC-000	35.60	FR. caliper BRACKET	1	
04	45105-APA-000-A	18.30	Pad COMP	1	
05	45126-X8A-000	119.50	FR brake hose ASSY	1	
06	45513-ANT-000	17.40	Oil cup	1	
07	46300-ANT-000	464.80	CBS control valve ASSY	1	
08	46516-ANT-000	119.80	Oil cup hose	1	
09	90145-M9Q-000	3.50	Oil bolt 10*22	2	
10	90545-M9Q-000	1.10	Oil bolt washer	4	

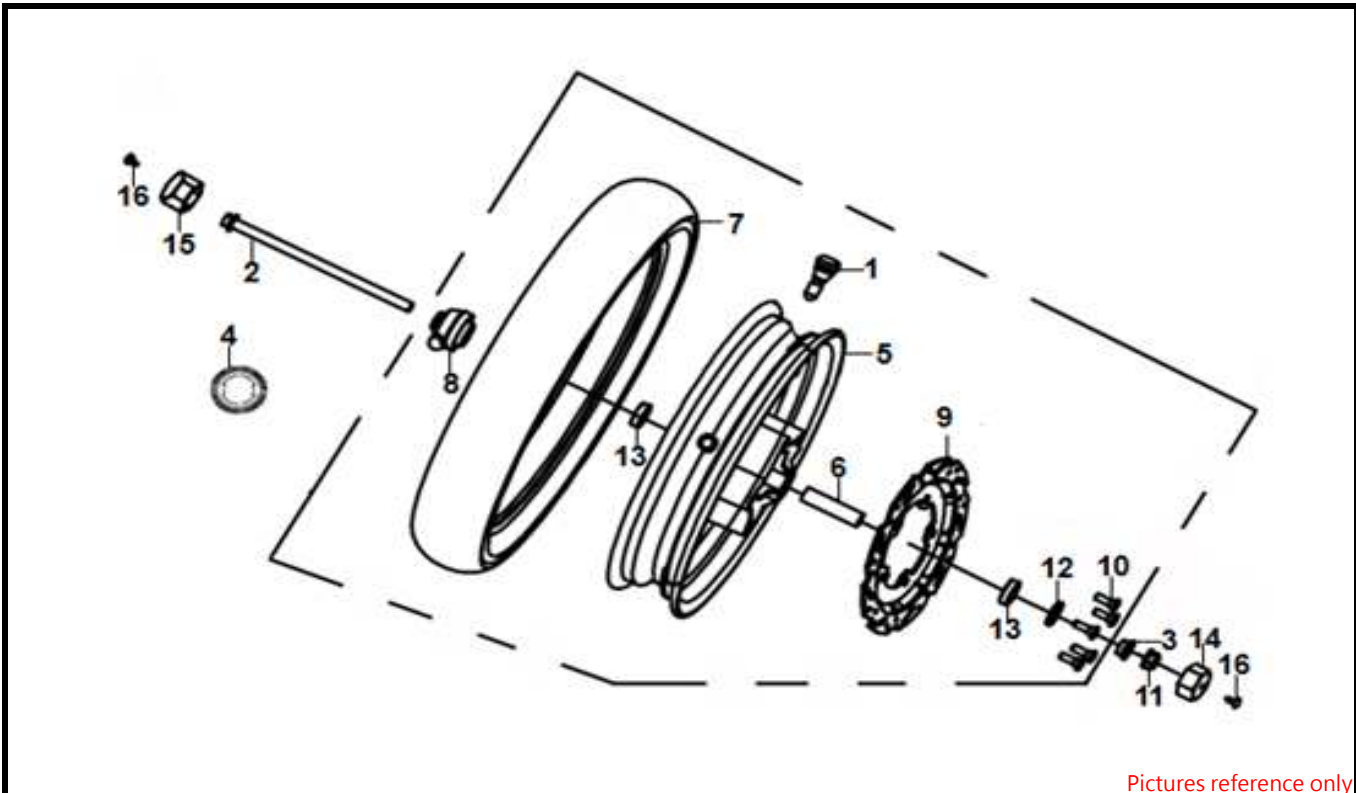

Pictures reference only

NO	PARTS NUMBER	PRICE ( RM / PCS )	DESCRIPTION	QTY	EFFECTIVE DATE
01	42753-ABA-000	11.20	Rim valve	1	
02	44301-APG-900	25.10	FR. wheel axle	1	
03	44311-GW0-910	6.40	Collar FR. wheel side	1	
04	91258-M9Q-000-M2	4.30	Speedometer gear box seal	1	
05	44601-X8A-000	561.00	FR. cast wheel COMP	1	
06	44620-APG-000	11.10	FR. axle dist collar	1	
07	44710-X8A-000	357.80	FR. tire	1	
08	44800-XPA-010	57.00	SPDMT. gear box ASSY	1	
09	45121-XMC-000	154.30	FR. brake disk	1	
10	90106-N02-0002	2.70	FR. disk bolt 8X24	5	
11	90306-X11-000	6.20	Self lock nut 12MM	1	
12	90754-M9Q-000	3.50	Dust seal 20X32X5	1	
13	90912-M9Q-000-M1	11.60	Bearing 6201	2	
14	44314-N7B-E10	2.10	L. FR. wheel axle rubber	1	
15	44315-N7B-E10	2.10	R. FR. wheel axle rubber	1	
16	93600-04010-04	1.10	Flat screw 4*10	2	

●Please check the color & stripe information according to the color index !

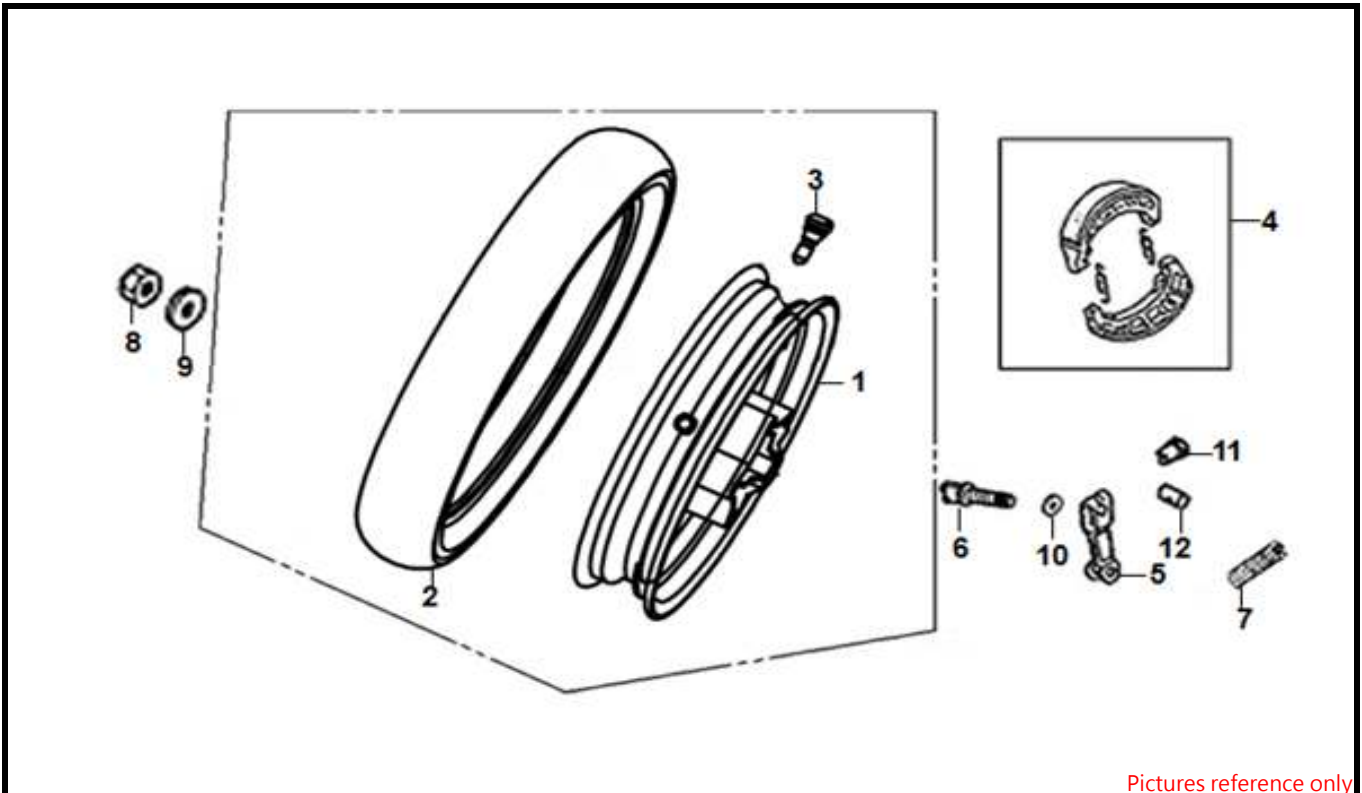

Pictures reference only

NO	PARTS NUMBER	PRICE ( RM / PCS )	DESCRIPTION	QTY	EFFECTIVE DATE
01	42601-X8A-000	509.50	RR. wheel hub COMP	1	
02	42710-X8A-000	366.40	RR. tire ASSY	1	
03	42753-ABA-000	11.20	Rim valve	1	
04	4312A-H1A-000	57.80	RR. brake shoe ASSY	1	
05	43410-KAA-0003	17.30	RR. brake arm	1	
06	43141-ANT-000	19.40	RR. brake cam	1	
07	43472-ABA-000	5.00	RR. BRK. Arm return SRG.	1	
08	90305-AAA-000	40.20	Self-lock nut 16MM	1	
09	90501-M9Q-900	6.10	16MM washer	1	
10	91352-M9Q-0000	0.70	O ring 11.3X1.3	1	
11	95015-32001	1.10	Brake arm joint B	1	
12	95015-42000-00	2.20	Adjust nut B	1	

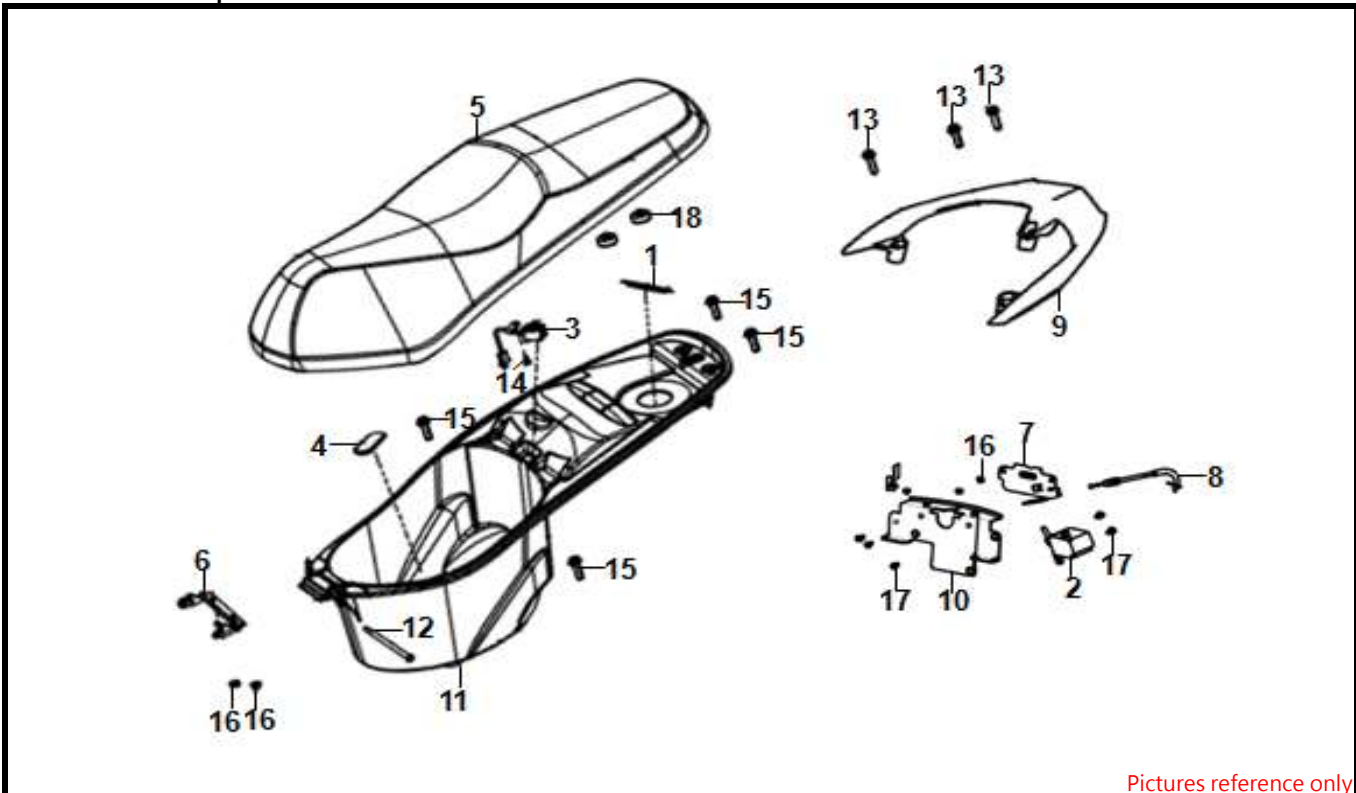

Pictures reference only

NO	PARTS NUMBER	PRICE ( RM / PCS )	DESCRIPTION	QTY	EFFECTIVE DATE
01	17506-XPA-000	3.30	Fuel guide rubber	1	
02	35870-HLA-000	71.90	Dc SOL. ASSY	1	
03	36600-A1A-010	18.00	Eng. Start control SW.	1	
04	70529-APA-000	9.60	Carb maint rubber	1	
05	77200-X8A-000	374.60	Double seat comp	1	
06	77201-AAA-000	18.20	Seat hinge comp.	1	
07	77230-APA-000	34.10	Seat catch comp.	1	
08	77240-XPA-000	26.30	Seat lock cable	1	
09	81200-X8A-000-K	213.50	RR. Carrier	1	
10	81207-XPA-000	47.70	Seat catch stay	1	
11	81250-XPA-000	138.70	Luggage box	1	
12	90105-HHA-000	7.20	Seat hing screw	1	
13	90106-B9A-000	4.30	Special bolt 8mm	3	
14	93903-34340	1.20	Tapping screw 4*12	1	
15	90115-ATA-000	2.00	Flange bolt 6*16	4	
16	94050-06040	0.40	Flange nut 6mm	5	
17	95701-06012-04	0.50	Flange bolt 6*12	5	
18	50352-ADB-000	3.30	Link stopper rubber	2	



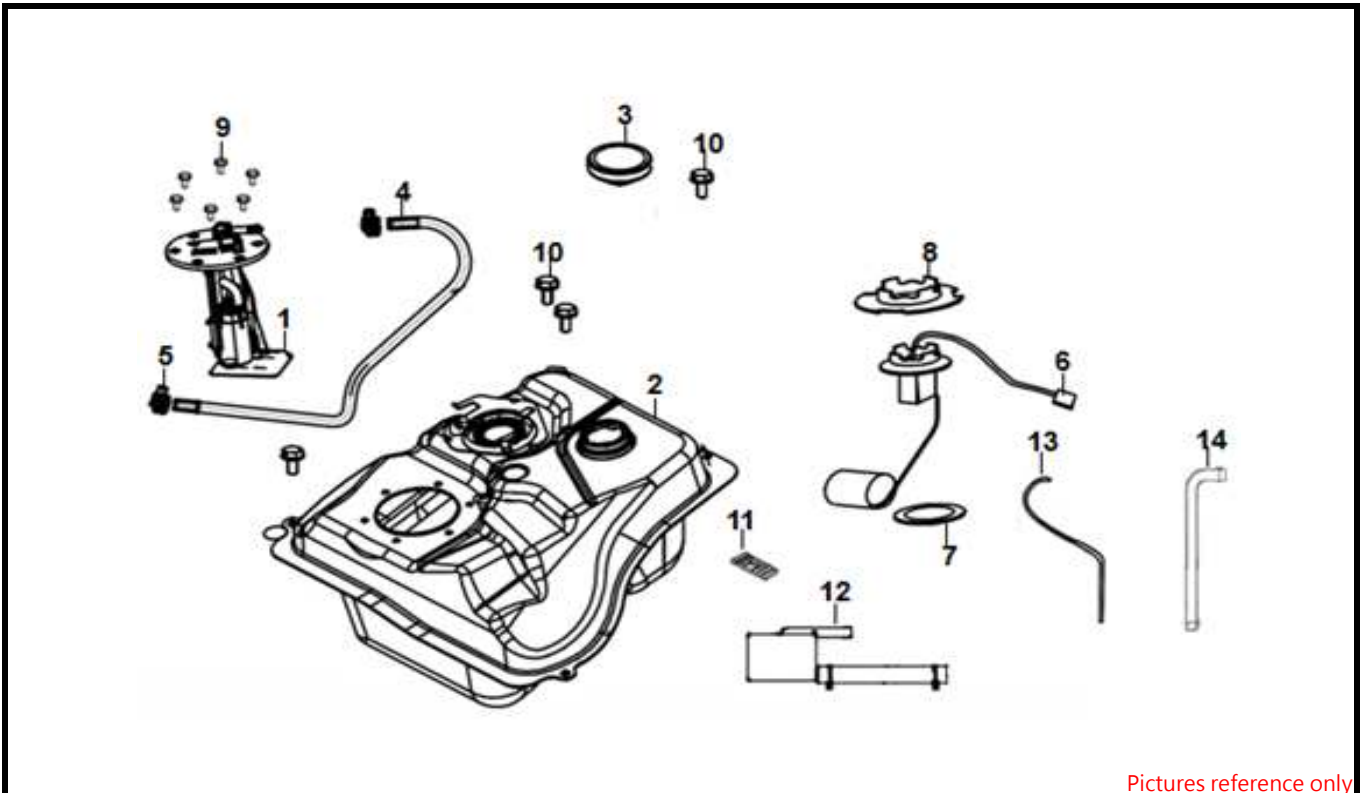

Pictures reference only

NO	PARTS NUMBER	PRICE ( RM / PCS )	DESCRIPTION	QTY	EFFECTIVE DATE
01	16700-XMA-000	736.30	Fuel pump comp.	1	
02	17500-XMB-000	172.80	Fuel tank comp.	1	
03	17620-XH1-010	50.60	Fuel filter cap comp	1	
04	17682-X8A-000	153.50	Fuel strainer hose	1	
05	19505-H5D-000	9.00	Hose clamp	1	
06	37800-XPA-010	33.60	Fuel unit assy	1	
07	37801-M9Q-000	2.20	Base packing	1	
08	37802-M9Q-000	4.30	Ret. Fuel unit	1	
09	90116-Z5C-000	1.60	Fuel pump. Bolt	6	
10	96001-06010-08	0.90	Flange bolt sh. 6*10	4	
11	17508-X8A-000	12.10	Fuel tank center cushion	1	
12	17580-XMB-000	48.10	Fuel cut valve	1	
13	17684-APA-000	17.30	Vacuum tube	1	
14	17685-XMC-000	9.50	CANI. - CARB. tube	1	

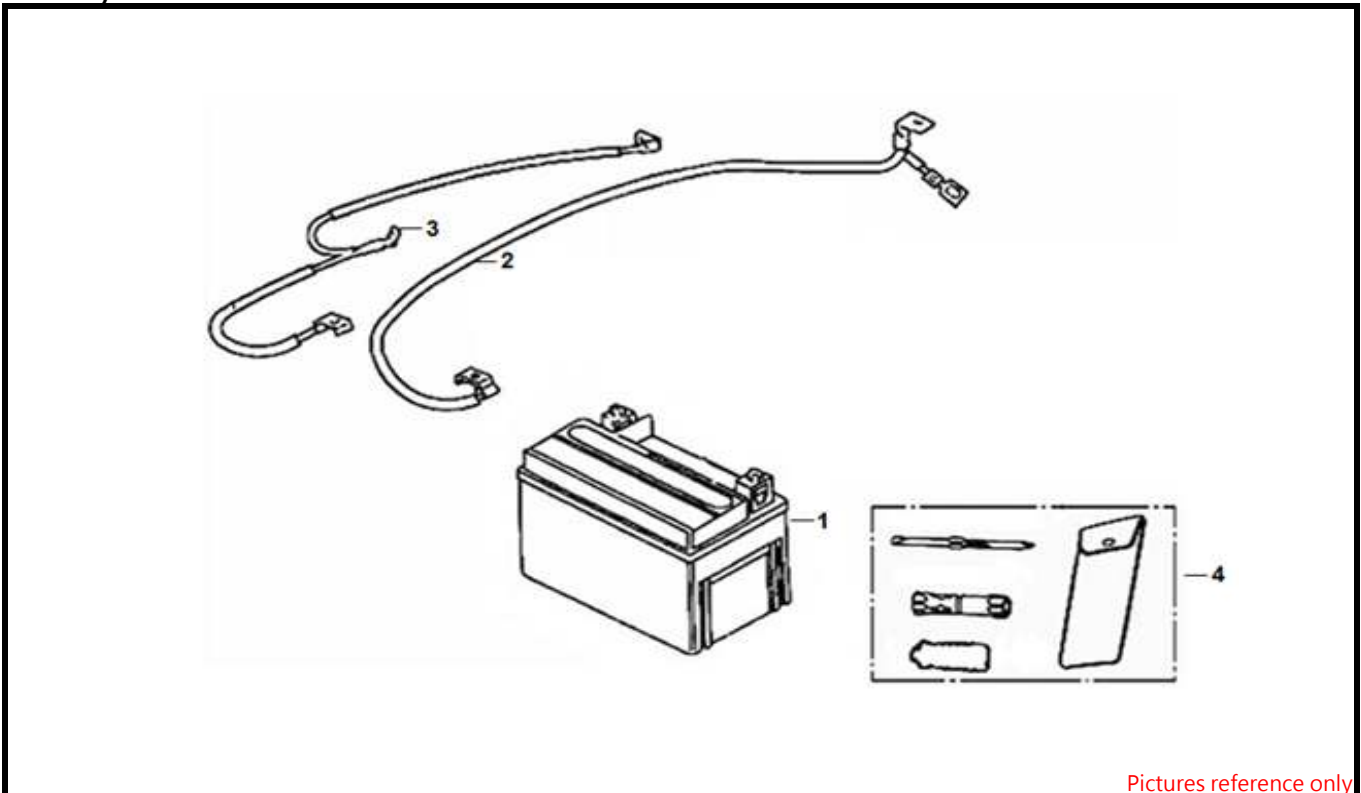

Pictures reference only

NO	PARTS NUMBER	PRICE ( RM / PCS )	DESCRIPTION	QTY	EFFECTIVE DATE
01	AC-YTX7A-BS(HW)	126.00	Battery ASS'Y(MT*7A-BS)	1	
02	32411-ARA-010	34.20	Battery cable	1	
03	32412-XRA-000	50.10	Earth cable	1	
04	89010-V1F-000	10.60	Tool set	1	

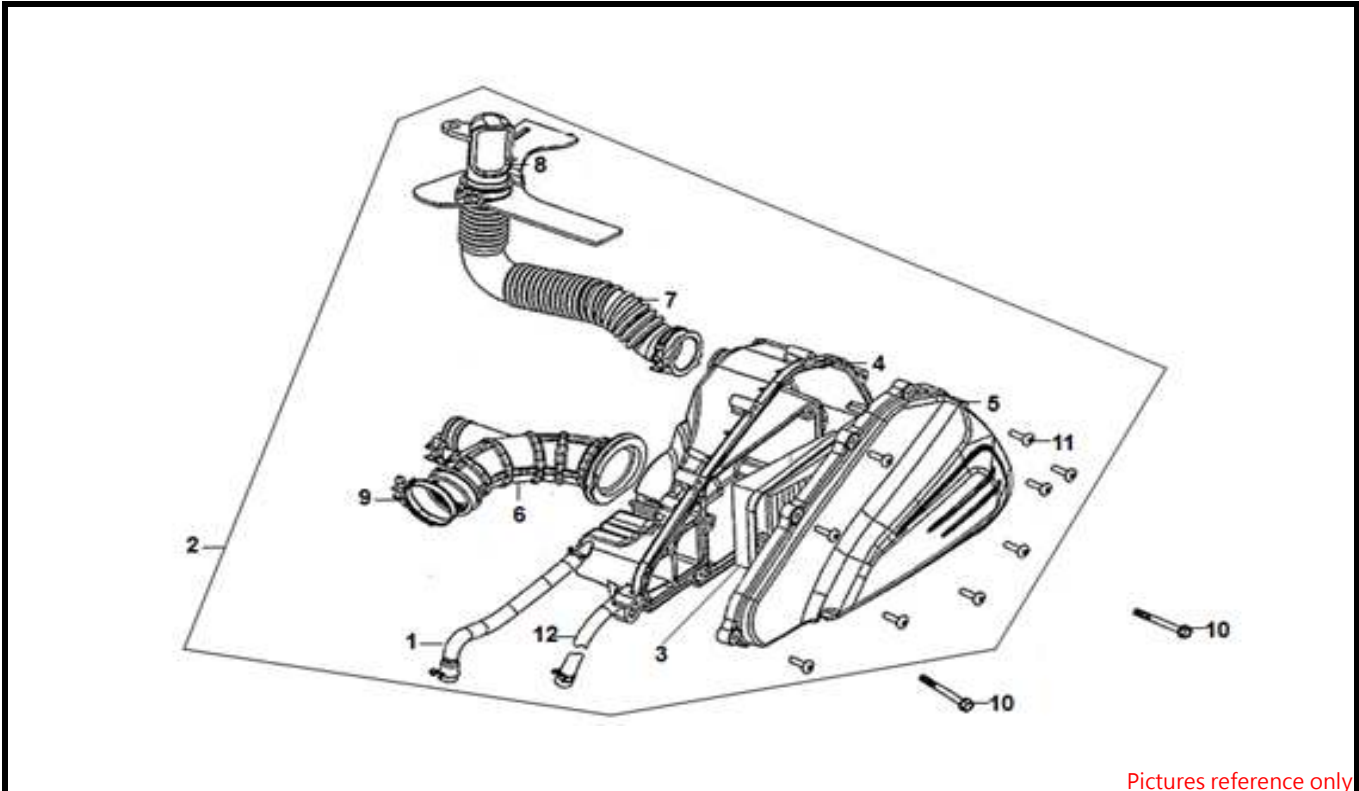

Pictures reference only

NO	PARTS NUMBER	PRICE ( RM / PCS )	DESCRIPTION	QTY	EFFECTIVE DATE
01	11211-Z7P-000	17.70	Breather tube	1	
02	17200-Z7P-020	259.60	AIR cleaner ASSY.	1	
03	17211-ADB-000	32.30	AIR/C element COMP.	1	
04	17230-ARA-010	48.30	AIR/C case COMP.	1	
05	17231-APA-000	39.20	AIR/C cover COMP.	1	
06	17253-XRB-010	62.00	AIR/C connecting tube	1	
07	17257-APA-000	74.30	AIR/C duct A	1	
08	17258-APA-000	15.20	AIR/C duct B	1	
09	90652-M9Q-000	9.00	AIR/C. CONN. tube band 48	1	
10	93404-06030-07	1.40	Washer bolt 6*30	2	
11	93903-25480	0.70	Tapping screw 5*20	9	
12	95003-23028-60	3.60	V tube 8*12*280	1	

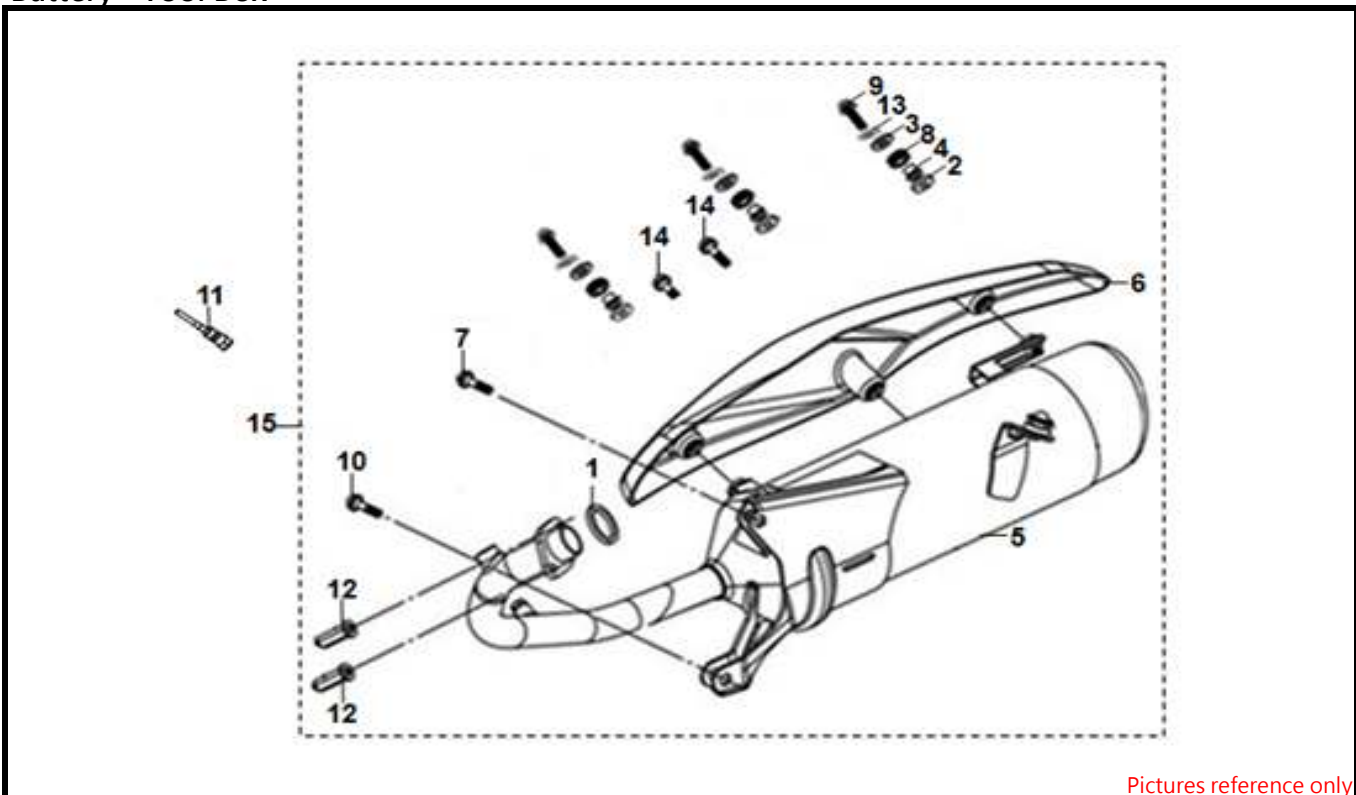

Pictures reference only

NO	PARTS NUMBER	PRICE ( RM / PCS )	DESCRIPTION	QTY	EFFECTIVE DATE
01	18291-Z8G-000	3.90	EXH. pipe gasket(26.2x33)	1	
02	18292-F3E-000	4.30	Protector packing A	3	
03	18293-F3E-000	1.10	Protector packing	3	
04	18295-F3E-000	2.90	Collar M6	3	
05	18300-X8A-000	1120.90	EXH. muffler COMP	1	
06	18317-XPA-000-K	104.20	Muffler protector COMP(BLACK)	1	
07	95801-ZDA-000	2.80	Flange bolt 8x45	1	
08	18320-F3E-0000	1.10	Protector rubber	3	
09	96001-06022-49	4.80	Bolt6*22	3	
10	95801-NBB-000	3.90	Flange bolt8*50	1	
11	3789A-XJE-000	541.70	O2 sensor ASSY.	1	
12	90043-XB1-000	5.90	Cap nut	2	
13	90555-AMA-000	0.70	Washer	3	
14	93903-25280	0.90	Tapping screw 5x12	2	
15	18000-X8A-000	1186.70	EXH muffler ASSY	1	

●Please check the color & stripe information according to the color index !

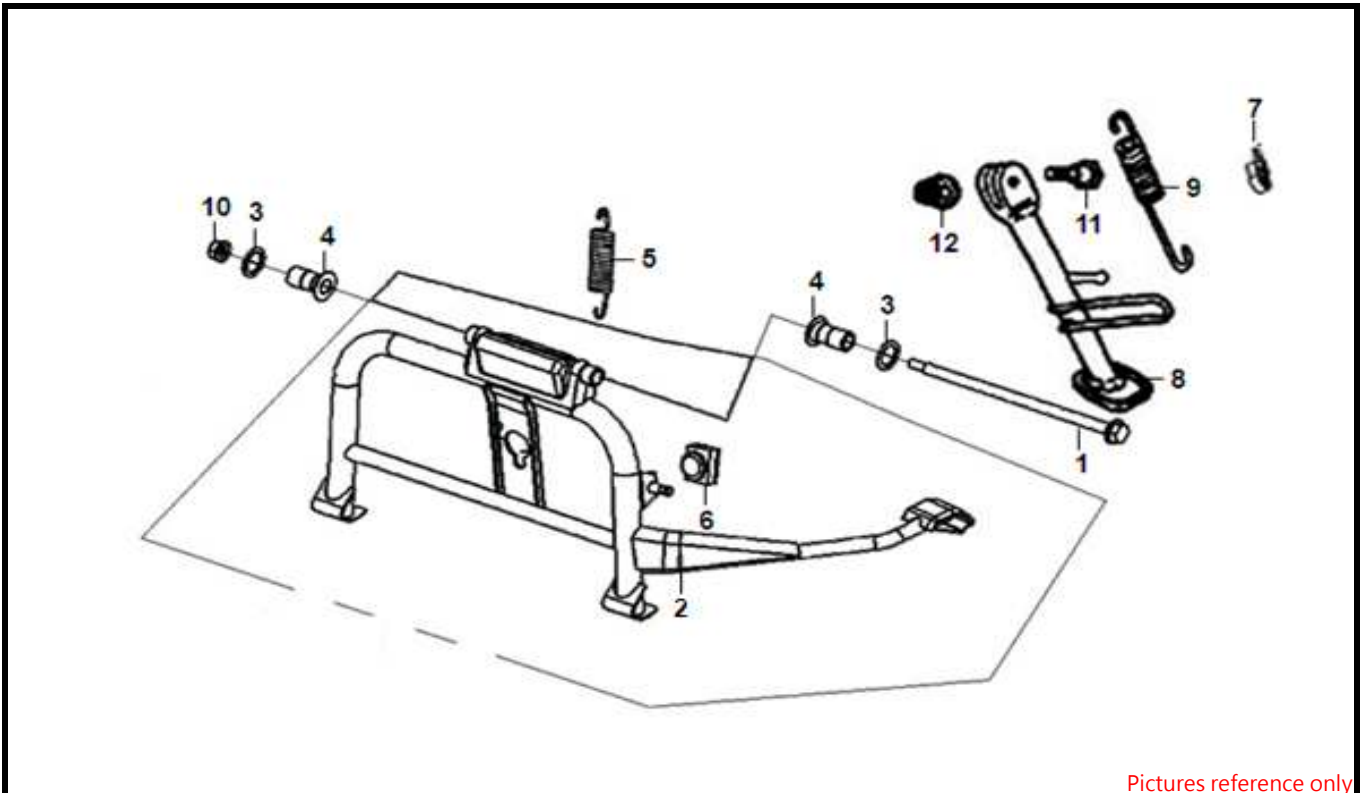

Pictures reference only

NO	PARTS NUMBER	PRICE ( RM / PCS )	DESCRIPTION	QTY	EFFECTIVE DATE
01	50512-ARA-000	12.50	Flange bolt	1	
02	50500-X8A-000	131.10	Main stand COMP	1	
03	50503-F6B-000	1.70	Main stand washer	2	
04	50504-Z6A-000	13.50	Main stand collar	2	
05	5052A-APA-900	12.40	Main stand SPG.ASSY	1	
06	50506-ABA-000	6.00	Stand stop rubber A	1	
07	35270-Z7C-000	153.60	Side stand SW.	1	
08	50530-X8A-000	34.20	Side stand COMP	1	
09	50535-Z7C-000	11.20	Side stand SPG. ASSY	1	
10	90309-M9Q-900	1.80	Self-lock nut 8MM	1	
11	90108-Z7C-010	4.60	Side stand pivot screw	1	
12	94030-08080-0S	0.40	HEX. nut 8MM	1	

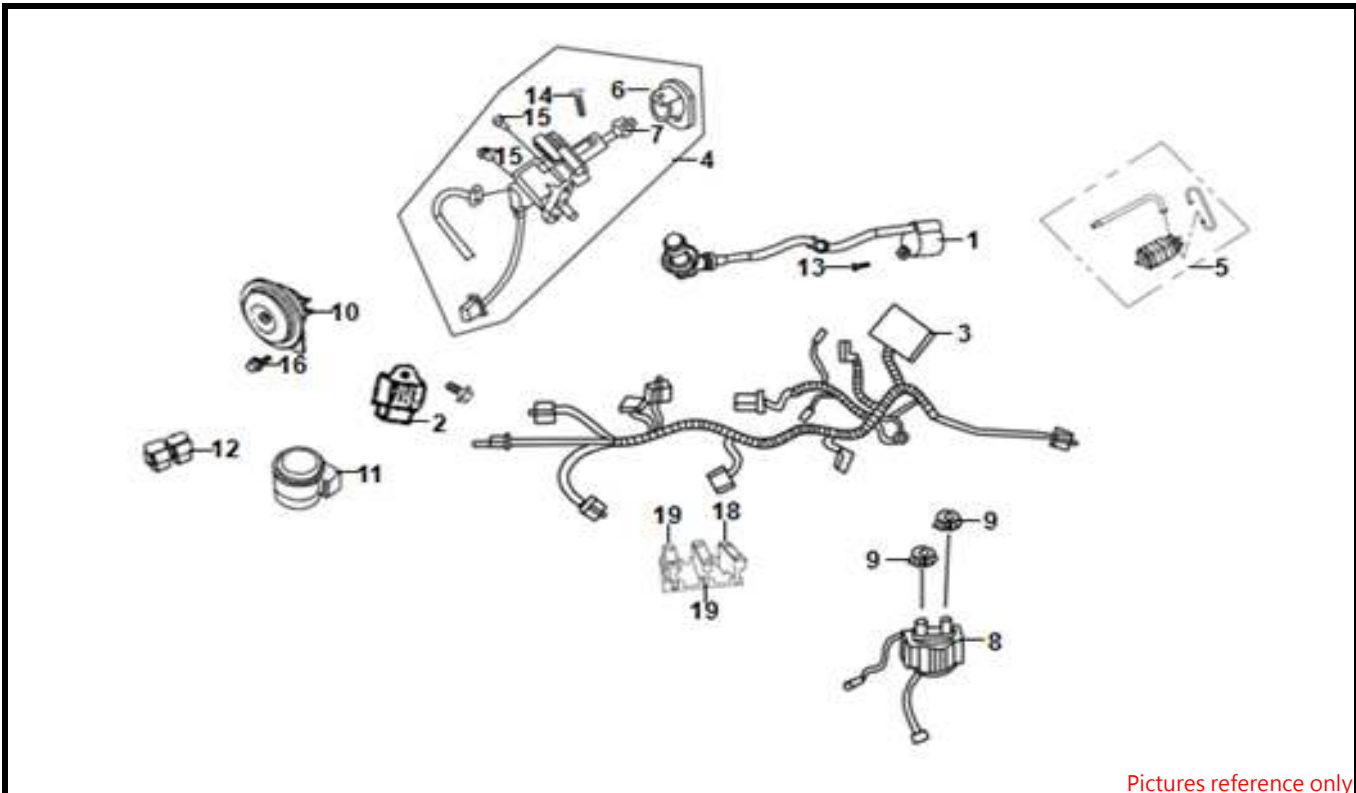

Pictures reference only

NO	PARTS NUMBER	PRICE ( RM / PCS )	DESCRIPTION	QTY	EFFECTIVE DATE
01	3051A-X8A-010	261.10	IGN. COIL. ASSY	1	
02	31600-MA1-000	162.60	REG. REC. COMP	1	
03	32100-X8A-010	771.70	Wire harness	1	
04	35010-X8A-010	134.30	Key set	1	
05	1730A-X8A-000	97.40	Canister set	1	
06	35114-ALA-000	24.90	Main SW.cover	1	
07	35111-XGA-000	32.80	Key	1	
08	3585A-35A-A00	47.00	MAG. SW. COMP	1	
09	35859-M9Q-000	0.90	Start MAG. SW. NUT	2	
10	38100-N7B-E10	34.70	Horn COMP	1	
11	38300-T40-010	39.60	Ap winker relay ASSY	1	
12	3850A-HLA-010	36.10	ELEC. relay ASSY	3	
13	90112-H5B-000	1.50	COIL SCREW 4mm	2	
14	93891-05010-08	1.20	Screw washer 5X10	1	
15	95801-06018-00	0.90	Flange bolt 6X18	2	
16	95801-08012-08	1.40	Flange bolt 8X12	1	
17	98200-31000	1.80	Blade fuse 10A	1	
18	98200-31500	1.10	Blade fuse 15A	1	
19	98200-32000	1.90	Plate fuse (20A)	1	

●Please check the color & stripe information according to the color index !

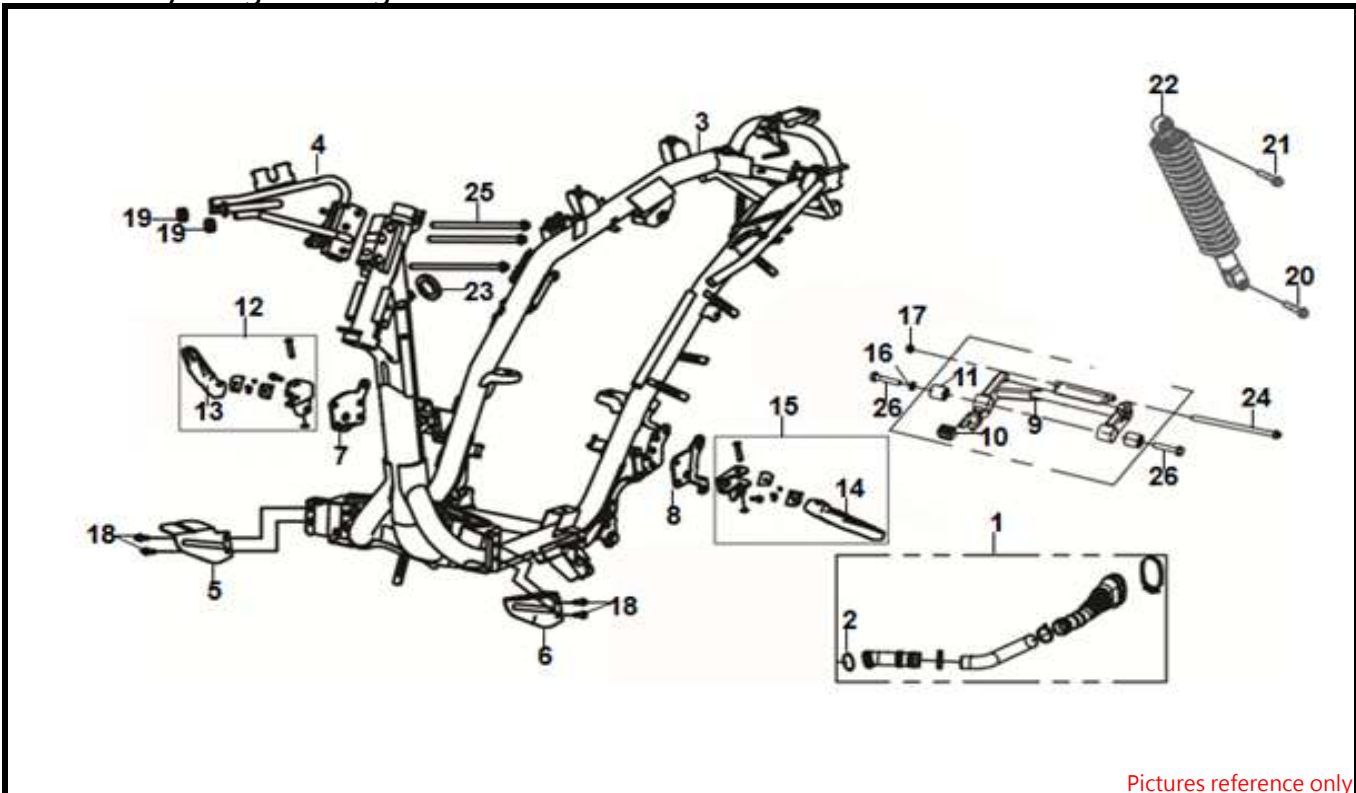

Pictures reference only

NO	PARTS NUMBER	PRICE ( RM / PCS )	DESCRIPTION	QTY	EFFECTIVE DATE
01	1134C-ARA-000	89.10	L. cover duct T ASSY	1	
02	17242-M9Q-000	2.50	AIR/C duct BAND	1	
03	50100-X8A-000	1226.50	Frame body COMP.	1	
04	50180-X8A-000	124.30	Front cover stay	1	
05	50181-X8A-010	35.90	Floor panel stay A	1	
06	50182-X8A-010	35.90	Floor panel stay B	1	
07	50183-X8A-000	19.20	RH. step STAY	1	
08	50184-X8A-000	19.20	LH. step STAY	1	
09	50351-ARA-010	108.30	ENG. hanger COMP	1	
10	50352-ADB-000	3.30	Link stopper rubber	1	
11	50353-M9Q-000	10.60	Swing lock bush	2	
12	50710-X8A-000	79.30	RH. pillion step ASSY	1	
13	50715-APA-000	56.40	RH. pillion step	1	
14	50718-APA-000	56.40	LH. pillion step	1	
15	50720-X8A-000	79.30	Lh. Pillion step ASSY	1	
16	90121-M9Q-900	2.00	Distance collar	1	
17	90304-M9Q-000	5.00	Flange. U nut 10mm	1	
19	94050-06040	0.40	Flange nut 6*40	2	
20	95801-08035-04	1.60	Flange bolt 8*35	1	
21	95801-10035-04	1.60	Flange bolt 10*35	1	
22	52400-AP1-000-K	150.20	Rr. Cushion ASSY	1	
23	64306-XPA-000	2.40	Inner box sponge	1	
24	90105-ARA-000	13.60	Flange bolt 10*191 (GREEN)	1	
25	90105-APA-000	11.50	Special bolt 6x45	3	
26	90106-ABA-000	3.70	Flange bolt 10*55	2	

PARTS NO.	NO.	PARTS NO.	NO.	PARTS NO.	NO.
06414-HKK-000	E14	14520-GY6-901	E05	17910-X8A-000	F02
11100-ARA-000	E04	14523-Z8G-000	E05	18000-X8A-000	F14
11102-M9Q-300	E04	14531-M9Q-000	E12	18241-F6S-000	E01
11102-M9Q-300	E12	14610-F8A-0001-L1	E03	18291-Z8G-000	F14
11192-XRB-000	E12	14711-F8A-000	E02	18292-F3E-000	F14
11200-ARA-000	E12	14721-F8A-000	E02	18293-F3E-000	F14
11203-M9Q-300	E12	14751-ARA-000	E02	18295-F3E-000	F14
11211-Z7P-000	F13	14771-F6C-A00	E02	18300-X8A-000	F14
11221-ARA-000	E11	14781-A01-A00	E02	18317-XPA-000-K	F14
11331-ARB-000	E06	15100-F6C-000	E04	18320-F3E-0000	F14
11341-XMA-020-K1	E08	15133-F6C-000	E04	19505-H5D-000	F11
11342-ARA-000	E08	15421-H66-000	E06	19510-XJ1-000	E07
11343-XRB-000	E08	15426-M9Q-000	E06	19613-GY6-900	E01
1134C-ARA-000	F17	1565A-ARA-000	E06	1961A-X8A-000	E01
11382-ARB-000	E08	15711-M92-000	E04	1962A-X8A-000	E01
11383-GY6-A00	E01	16201-Z2D-000	E02	1963A-Z7P-000	E01
11394-Z2D-000	E06	16211-ANL-010	E02	1B01A6101	E09
11395-XRB-000	E08	1640A-XRB-010	E14	1C14401-M92-000	E03
12100-ARA-000	E05	16700-XMA-000	F11	AC-1PCR7HSA-3	E02
12191-Z2D-000	E05	1711A-Z7P-000	E14	AC-YTX7A-BS(HW)	F12
12209-H6B-0000	E02	17120-XJA-000	E14	21200-ANM-000	E11
1220C-XGG-000	E02	17121-H6Y-000	E14	21395-Z2D-000	E11
12251-H7A-000	E02	17200-Z7P-020	F13	22101-F6C-000	E10
12302-ANL-000	E02	17211-ADB-000	F13	22102-M92-000	E09
12308-ARA-000	E02	17230-ARA-010	F13	22105-M92-000	E09
12310-A61-000	E02	17231-APA-000	F13	22110-H5B-000	E09
12361-M9Q-0000	E06	17242-M9Q-000	F17	2211A-ARA-000	E09
12391-F8A-0001	E02	17253-XRB-010	F13	22121-HKE-000-A	E09
13000-ANL-000	E13	17256-MA1-000	E14	22131-M92-000	E09
13010-U3A-000	E13	17257-APA-000	F13	22132-ARA-000-A	E09
13101-ANL-000	E13	17258-APA-000	F13	22350-ANL-000	E10
13111-ARA-000	E13	1730A-X8A-000	F16	22530-ANT-000	E10
14100-ANL-000	E03	17500-XMB-000	F11	2301A-ANT-000	E10
14105-F6A-000	E03	17506-XPA-000	F10	23411-ARA-000	E11
14439-F62-010	E02	17508-X8A-000	F11	23420-Z7C-010	E11
1443A-ANL-010	E02	17580-XMB-000	F11	23431-ANL-000	E11
14451-ANL-000	E02	17620-XH1-010	F11	23432-AR1-000	E11
14452-ANL-000	E02	17682-X8A-000	F11	28101-M9Q-000	E04
14457-ANL-000	E03	17684-APA-000	F11	28102-M9Q-000	E04
14510-F8A-0001-L1	E03	17685-XMC-000	F11	28110-M9Q-000	E04



PARTS NO.	NO.	PARTS NO.	NO.	PARTS NO.	NO.
28120-M9Q-000	E04	38300-T40-010	F16	50301-M9Q-000	F06
28124-H6T-000	E04	3850A-HLA-010	F16	50302-M9Q-000	F06
28125-M92-000	E04	42601-X8A-000	F09	50303-AAA-000	F06
28126-M9Q-000	E04	42710-X8A-000	F09	50304-AAA-000	F06
2812A-H6T-000-M1	E04	42753-ABA-000	F08	50306-M9Q-000	F06
3051A-X8A-010	F16	42753-ABA-000	F09	50324-X8A-000	F04
31110-F6T-000	E07	4312A-H1A-000	F09	50326-X8A-000	F04
31120-X8A-000	E07	43141-ANT-000	F09	50351-ARA-010	F17
31200-ARA-000	E12	43410-KAA-0003	F09	50352-ADB-000	F10
31600-MA1-000	F16	43450-X8A-000	F02	50352-ADB-000	F17
32100-X8A-010	F16	43472-ABA-000	F09	50353-M9Q-000	F17
32411-ARA-010	F12	44301-APG-900	F08	50500-X8A-000	F15
32412-XRA-000	F12	44311-GW0-910	F08	50503-F6B-000	F15
32961-ARA-000	E06	44314-N7B-E10	F08	50504-Z6A-000	F15
33100-X8A-000	F03	44315-N7B-E10	F08	50506-ABA-000	F15
33400-X8A-000	F03	44601-X8A-000	F08	50512-ARA-000	F15
33450-X8A-000	F03	44620-APG-000	F08	5052A-APA-900	F15
33700-X8A-000	F05	44710-X8A-000	F08	50530-X8A-000	F15
33701-X8A-000	F05	44800-XPA-010	F08	50535-Z7C-000	F15
33740-Z6A-000	F05	44830-X8A-000	F02	50611-APA-000	F04
33741-N7B-E10	F05	45100-XMC-000-K	F07	50612-APA-000	F04
33742-X8A-000	F06	45101-XMC-000	F07	50710-X8A-000	F17
35010-X8A-010	F16	45105-APA-000	F07	50715-APA-000	F17
35111-XGA-000	F16	45105-APA-000-A	F07	50718-APA-000	F17
35114-ALA-000	F16	45106-APA-000	F07	50720-X8A-000	F17
35150-X8A-000	F02	45121-XMC-000	F08	51400-X8A-000-K	F06
35200-X8A-000	F02	45126-X8A-000	F07	51403-APA-000	F06
35270-Z7C-000	F15	45156-AAA-000	F06	51404-APA-000	F06
35340-M92-900	F02	45450-X8A-000	F02	51500-X8A-000-K	F06
35859-M9Q-000	F16	45465-ZDA-000	F06	52400-AP1-000-K	F17
3585A-35A-A00	F16	4500A-X8A-000	F07	53100-X8A-000	F02
35870-HLA-000	F10	45513-ANT-000	F07	53104-AWR-000	F02
36600-A1A-010	F10	46300-ANT-000	F07	53125-CT1C-A00	F02
37200-X8A-010	F01	46516-ANT-000	F07	53131-AWU-000-KH	F02
37800-XPA-010	F11	50100-X8A-000	F17	53132-AWU-000	F02
37801-M9Q-000	F11	50180-X8A-000	F17	53140-XPA-0001-VN1-V	F02
37802-M9Q-000	F11	50181-X8A-010	F17	53166-XPA-0001-VN	F02
37880-Z5C-000-M1	E02	50182-X8A-010	F17	53175-ANT-000	F02
3789A-XJE-000	F14	50183-X8A-000	F17	53178-ATA-000	F02
38100-N7B-E10	F16	50184-X8A-000	F17	53181-ANT-000	F02

PARTS NO.	NO.	PARTS NO.	NO.	PARTS NO.	NO.
53182-X8A-000	F02	80108-X8A-000	F05	87131-X8B-000-T3	F04
5318A-X8A-000	F02	80151-X8A-000	F05	87132-X8B-000-T1	F04
53192-X8A-000	F02	81131-X8A-900	F03	87132-X8B-000-T2	F04
5319A-X8A-000	F02	81132-X8A-000	F03	87132-X8B-000-T3	F04
53200-X8A-000	F06	81133-X8A-000-AE	F03	87170-X8B-000	F02
53205-X8A-000	F02	81141-X8A-000	F03	87552-L6G-900	F03
53206-X8A-000	F01	81142-X8A-000	F03	88110-XPA-000-K	F02
53208-X9B-000	F01	81143-X8A-000-AE	F03	88120-XPA-000-K	F02
53209-X9B-000	F01	81146-X8A-000	F03	89010-V1F-000	F12
53211-M9Q-0000	F06	81200-X8A-000-K	F10	90001-M9Q-000	E05
53212-M9Q-000	F06	81207-XPA-000	F10	90002-M9Q-000	E04
53214-M9Q-0000	F06	81250-XPA-000	F10	90005-KW1-900	E05
53215-M9Q-0000	F06	83500-X8A-000-BP	F05	90031-107-010	E05
53231-X8A-000	F02	83500-X8A-000-RD	F05	90032-A6A-000	E05
61100-X8A-000-K	F06	83500-X8A-000-WA	F05	90033-M92-000	E02
61110-X8A-000	F06	83510-X8A-000-AE	F05	90034-HMA-000	E02
64300-X8A-000	F03	83520-X8A-000	F04	90043-XB1-000	F14
64301-X8A-000-BP	F03	83530-X8A-000-AE	F04	90083-B12-000	E03
64301-X8A-000-RD	F03	83600-X8A-000-BP	F05	90085-HHA-900	E14
64301-X8A-000-WA	F03	83600-X8A-000-RD	F05	90103-KN8-000	E12
64302-X8A-000-BP	F03	83600-X8A-000-WA	F05	90105-APA-000	F17
64302-X8A-000-RD	F03	83610-X8A-000-AE	F05	90105-ARA-000	F17
64302-X8A-000-WA	F03	83620-X8A-000	F04	90105-HHA-000	F10
64303-X8A-000	F01	83630-X8A-000-AE	F04	90106-AAA-000	F02
64306-X01-000	F04	83650-X8A-000-BP	F05	90106-ABA-000	F17
64306-XPA-000	F17	83650-X8A-000-RD	F05	90106-B9A-000	F10
64310-X8A-000	F04	83650-X8A-000-WA	F05	90106-N02-0002	F08
64318-ALA-000-BK	F03	87123-X8B-000-T1	F03	90108-Z7C-010	F15
67100-X8A-000	F01	87123-X8B-000-T2	F03	90111-AAA-000	F04
67110-X8A-000-AE	F01	87124-X8B-000-T1	F03	90112-H5B-000	F16
70529-APA-000	F10	87124-X8B-000-T2	F03	90115-ATA-000	F06
77200-X8A-000	F10	87125-X8B-000-T1	F05	90115-ATA-000	F10
77201-AAA-000	F10	87125-X8B-000-T2	F05	90115-AWU-000	F02
77230-APA-000	F10	87126-X8B-000-T1	F05	90116-Z5C-000	F11
77240-XPA-000	F10	87126-X8B-000-T2	F05	90118-B9A-000	F03
80100-X8A-000	F05	87128-X8B-000	F05	90118-B9A-000	F04
80103-ARA-000	F05	87129-X8B-000	F05	90121-M9Q-900	F17
80105-X8A-000	F04	87130-X8B-000	F05	90145-M9Q-000	F07
80106-ARA-000	F05	87131-X8B-000-T1	F04	90164-AAA-000	F06
80107-X8A-000	F05	87131-X8B-000-T2	F04	90201-GY6-900	E04

## PARTS NO. INDEX

PARTS NO.	NO.	PARTS NO.	NO.	PARTS NO.	NO.
90302-SA4-900	F01	92800-12000	E12	95015-42000-00	F09
90302-SA4-900	F03	93404-06016-00	F04	95701-06012-04	F04
90302-SA4-900	F04	93404-06022	F17	95701-06012-04	F10
90302-SA4-900	F05	93404-06030-07	F13	95701-08055-00	E12
90304-AAA-000	F02	93600-04010-04	F08	95701-08060-00	E12
90304-M9Q-000	F17	93600-06025-0H	E04	95701-08065-00	E12
90305-AAA-000	F09	93891-05010-08	F16	95701-08068-00	E12
90306-X11-000	F08	93903-25280	F14	95801-06014-07	F06
90309-M9Q-900	F15	93903-25480	F13	95801-06018-00	F16
90401-ANL-000	E11	93903-34180	E02	95801-06022-04	F04
90403-M92-000	E04	93903-34340	E01	95801-08012-08	F16
90440-166-000	E07	93903-34340	F03	95801-08035-04	F17
90440-166-000	E09	93903-34340	F05	95801-08040-00	F06
90442-028-000	E02	93903-34340	F10	95801-10035-04	F17
90474-333-000	E12	93903-35240	F01	95801-ZDA-000	F14
90501-M9Q-900	F09	93903-35240	F03	96001-06010-08	F11
90545-M9Q-000	F07	93903-35240	F04	96001-06012-04	E03
90555-AMA-000	F14	93903-35240	F05	96001-06012-08	E04
90602-N01-000	E04	93903-35340	F03	96001-06016-08	E12
90652-M9Q-000	F13	93903-45240	F04	96001-06018-08	E07
90703-M8Q-000	E05	93903-45340	F02	96001-06020-00	E07
90703-M8Q-000	E11	93904-35340	E01	96001-06022-49	F14
90703-M8Q-000	E12	93904-35380	E01	96001-06025-08	E01
90754-M9Q-000	F08	93930-14480	F04	96001-06028-08	E07
90912-M9Q-000-M1	F08	94030-08080-0S	F15	96001-06030-00	E08
91003-M8Q-000	E11	94050-06040	F10	96001-06030-08	E06
91104-KN7-670	E11	94050-06040	F17	96001-06045-00	E14
91104-M9Q-000	E04	94050-08080	E02	96001-06045-08	E04
91105-M9Q-000	E04	94050-12000	E07	96001-06050-02	E14
91201-M9Q-300-M1	E04	94050-12000	E09	96001-06055-08	E04
91202-KJ9-003	E11	94050-12000	E10	96001-06095-08	E02
91203-A6A-000	E11	94109-12000	E12	96001-06095-08	E06
91204-HMA-000	E09	94301-08140	E06	96001-06100-08	E06
91258-M9Q-000-M2	F08	94301-08140	E12	96100-62030-00	E11
91301-GR0-003	E12	94510-25000	E11	96100-63013-00	E11
91302-M9T-000	E06	94591-17000	E01	96150-62050-10	E11
91306-GY6-A00	E05	94591-28000	E12	96700-06025-49	F02
91352-M9Q-0000	F09	94601-15000-00	E13	96700-08020-02	F02
95801-NBB-000	F14	95003-23028-60	F13	98200-31000	F16
92101-05012-0A	E07	95015-32001	F09	98200-31500	F16

MODEL:XC12W1-MYC

# PARTS NO. INDEX

2018.03

PARTS NO.	NO.	PARTS NO.	NO.	PARTS NO.	NO.
98200-32000	F16				